

NOTICE!!

These documents have been scanned!

Do not place un-scanned documents beneath this notice!

Do not remove this notice from this file!

GPO Jacket No. 560-102
Print Order 61540
Rise Business Services, LLC
Job=AZ15 5/14/2019



Box Number= AZ15050



Claim Begin-End: AMC414304-AMC414311

1 Initial Receipt



AZ15050-10

AMC414065-AMC414430

**NO
DOCUMENTS
FOUND**

NO DOCUMENTS FOUND
NO DOCUMENTS FOUND

NOTICE!!

These documents have been scanned!

Do not place un-scanned documents beneath this notice!

Do not remove this notice from this file!

GPO Jacket No. 560-102
Print Order 61540
Rise Business Services, LLC
Job=AZ15 5/14/2019



Box Number= AZ15050



Claim Begin-End: AMC414304-AMC414311

2 Correspondence



AZ15050-10 AMC414065-AMC414430

**NO
DOCUMENTS
FOUND**

NO DOCUMENTS FOUND
NO DOCUMENTS FOUND

NOTICE!!

These documents have been scanned!

Do not place un-scanned documents beneath this notice!

Do not remove this notice from this file!

GPO Jacket No. 560-102
Print Order 61540
Rise Business Services, LLC
Job=AZ15 5/14/2019



Box Number= AZ15050



Claim Begin-End: AMC414304-AMC414311

3 Transfers



AZ15050-10

AMC414065-AMC414430

**NO
DOCUMENTS
FOUND**

NO DOCUMENTS FOUND
NO DOCUMENTS FOUND

NOTICE!!

These documents have been scanned!

Do not place un-scanned documents beneath this notice!

Do not remove this notice from this file!

GPO Jacket No. 560-102
Print Order 61540
Rise Business Services, LLC
Job=AZ15 5/14/2019



Box Number= AZ15050



Claim Begin-End: AMC414304-AMC414311

4 Miscellaneous



AZ15050-10

AMC414065-AMC414430

United States Department of the Interior
Bureau of Land Management
LANDS/RECREATION & PLANNING
ONE N CENTRAL AVE
PHOENIX, AZ 85004 -2203
Phone: 602-417-9200

Receipt

No:

2529159

Transaction #: 2607422
Date of Transaction: 03/07/2012

ENTERED INTO COMPUTER

CUSTOMER:

MAR 16 2012

98

NORMAN MONTGOMERY
PO BOX 941
COOLIDGE, AZ 85128-0018 US

LINE #	QTY	DESCRIPTION	REMARKS	UNIT PRICE	TOTAL
1	8.00	LOCATABLE MINERALS / MINING CLAIMS-NEW, UNADJUD, ONE OR MORE AUTH NOS / NEW MINING CLAIM LOCATION FEE \$34 CASES: AMC414304/\$34.00, AMC414305/\$34.00, AMC414306/\$34.00, AMC414307/\$34.00, AMC414308/\$34.00, AMC414309/\$34.00, AMC414310/\$34.00, AMC414311/\$34.00		- n/a -	272.00
2	8.00	LOCATABLE MINERALS / MINING CLAIMS-NEW, UNADJUD, ONE OR MORE AUTH NOS / NEW MINING CLAIM MAINT FEE \$140 CASES: AMC414304/\$140.00, AMC414305/\$140.00, AMC414306/\$140.00, AMC414307/\$140.00, AMC414308/\$140.00, AMC414309/\$140.00, AMC414310/\$140.00, AMC414311/\$140.00		- n/a -	1120.00
3	8.00	LOCATABLE MINERALS / MINING CLAIMS-NEW, UNADJUD, ONE OR MORE AUTH NOS / NEW MINING CLAIM PROCESSING FEE \$15 CASES: AMC414304/\$15.00, AMC414305/\$15.00, AMC414306/\$15.00, AMC414307/\$15.00, AMC414308/\$15.00, AMC414309/\$15.00, AMC414310/\$15.00, AMC414311/\$15.00		- n/a -	120.00
4	8.00	LOCATABLE MINERALS / MINING CLAIMS-NEW, UNADJUD, ONE OR MORE AUTH NOS / NEW MINING CLAIM MAINT FEE \$140 CASES: AMC414304/\$140.00, AMC414305/\$140.00, AMC414306/\$140.00, AMC414307/\$140.00, AMC414308/\$140.00, AMC414309/\$140.00, AMC414310/\$140.00, AMC414311/\$140.00	ENTERED INTO COMPUTER MAINT 2013/8 MAR 20 2012	- n/a -	1120.00

TOTAL:

\$2,632.00

PAYMENT INFORMATION

1	AMOUNT:	2632.00	POSTMARKED:	N/A
	TYPE:	CHECK	RECEIVED:	03/07/2012
	CHECK NO:	26508		
	NAME:	MONTGOMERY, NORMAN PO BOX 941 COOLIDGE AZ 85128-0018 US		

NOTICE!!

These documents have been scanned!

Do not place un-scanned documents beneath this notice!

Do not remove this notice from this file!

GPO Jacket No. 560-102
Print Order 61540
Rise Business Services, LLC
Job=AZ15 5/14/2019



Box Number= AZ15050



Claim Begin-End: AMC414304-AMC414311

5 Annual Filings



AZ15050-10

AMC414065-AMC414430

UNITED STATES
DEPARTMENT OF THE INTERIOR
BUREAU OF LAND MANAGEMENT
**MAINTENANCE FEE PAYMENT FORM
FOR PLACER MINING CLAIMS**

62617
83517
4000.19
414304

Remitter Name: Norman Montgomery

Mailing Address: P.O. Box 941

City, State, Zip: Coolidge, Az. 85128

☐ Check here if this is a change of address.

FOR COUNTY RECORDER'S USE

No. of claims 20

Total due BLM \$ _____

1. The maintenance fee may be paid by cash, check, money order, Bureau of Land Management (BLM) Declining Deposit Account, or credit card (VISA, American Express, Discover, or MasterCard). Payments must be remitted to the BLM State Office where your claim or site is recorded and received on or before September 1. If the payment is mailed, the envelope must be postmarked by a bona fide delivery service on or before September 1 and received at the proper BLM State Office within 15 calendar days after the due date. Payments may also be made by telephone using a credit card. A complete listing of BLM State Offices with their addresses and phone numbers can be found at <http://www.blm.gov>.
2. The maintenance fee for the following claim(s) applies to the assessment year _____.

CLAIM NAME	BLM SERIAL NO.	ACRES IN CLAIM	PAYMENT DUE TO THE BLM (See Instructions on Page 2)
Bonanza	83517	160	1240
Esperanza	83518	160	1240
Horseshoe	83519	20.6	310
Arizona	83520	30	155
Nuget	83521	20.66	310
Bell	83522	20.66	310
Shur Shot	83523	160	1240
Hard Nut	62617	160	1240

ENTERED
AUG 13 2018

Use a separate sheet for additional claim names, serial numbers, and claimant names and addresses.

BY: _____

4232055

(Continued on page 2)

RECEIVED
BLM AZ STATE OFFICE
211 M
AUG 10 A 10:00
PHOENIX, ARIZONA

(4)

UNITED STATES
DEPARTMENT OF THE INTERIOR
BUREAU OF LAND MANAGEMENT
**MAINTENANCE FEE PAYMENT FORM
FOR PLACER MINING CLAIMS**

400019
400020
400021
400022

Remitter Name: Norman Montgomery

Mailing Address: P.O. Box 941

City, State, Zip: Coolidge, Az. 85128

☐ Check here if this is a change of address.

FOR COUNTY RECORDER'S USE

No. of claims 20

Total due BLM \$ _____

1. The maintenance fee may be paid by cash, check, money order, Bureau of Land Management (BLM) Declining Deposit Account, or credit card (VISA, American Express, Discover, or MasterCard). Payments must be remitted to the BLM State Office where your claim or site is recorded and received on or before September 1. If the payment is mailed, the envelope must be postmarked by a bona fide delivery service on or before September 1 and received at the proper BLM State Office within 15 calendar days after the due date. Payments may also be made by telephone using a credit card. A complete listing of BLM State Offices with their addresses and phone numbers can be found at <http://www.blm.gov>.
2. The maintenance fee for the following claim(s) applies to the assessment year _____.

CLAIM NAME	BLM SERIAL NO.	ACRES IN CLAIM	PAYMENT DUE TO THE BLM (See Instructions on Page 2)
Pajaro	400019	20.66	155
Reymert	400020	20.66	155
Sting #6	400021	20.66	155
Watsonville	400022	20.66	155
Aptos	414304	13.86	155
Capitola	414305	20.66	155
Miramar	414306	20.66	155
Sting #1	414307	20.48	155
Sting #2	414308	10.36	155
Sting #3	414309	17.89	155

RECEIVED
BLM AZ STATE OFFICE
2018 AUG 10 A 10:00
PHOENIX, ARIZONA

Use a separate sheet for additional claim names, serial numbers, and claimant names and addresses.

ENTERED
AUG 13 2018
(Continued on page 2)
BY: _____

SUPPLEMENTAL ATTACHMENT

May be used with the following forms for listing additional mining claims:

Check One.

- ☐ Affidavit of Performance of Annual Work
- ☐ Maintenance Fee Payment
- ☐ Notice of Intent to Hold Mining Claims
- ☐ Notice of Non-Liability for Labor and Materials Furnished
- ☐ Quit claim Deed

BLM
Date
Stamp

RECEIVED
BIRMINGHAM AZ STATE OFFICE
2018 AUG 10 A 10:00
PHOENIX, ARIZONA

[illegible]

Form MCF114
Revised July 2014

This form is available from the **Arizona Geological Survey** and may be reproduced.

United States Department of the Interior
Bureau of Land Management
DIV OF LANDS, MINRLS & ENERGY
ONE N CENTRAL AVE
PHOENIX, AZ 85004 -4427
Phone: 602-417-9200

Receipt

No: 4232055

Transaction #: 4347345	
Date of Transaction: 08/10/2018	
CUSTOMER:	
	NORMAN MONTGOMERY PO BOX 941 COOLIDGE, AZ 85128-0018 US

LINE #	QTY	DESCRIPTION	REMARKS	UNIT PRICE	TOTAL
1	1.00	LOCATABLE MINERALS / MINING CLAIMS- NOT NEW-UNADJUD, ONE AUTH NO. ONLY / MINING CLAIM MONEY RECEIVED CASES: AMC83517/\$7905.00	MAINT 2019/20	- n/a -	7905.00
TOTAL:					\$7,905.00

PAYMENT INFORMATION				
1	AMOUNT:	7905.00	POSTMARKED:	N/A
	TYPE:	CHECK	RECEIVED:	08/10/2018
	CHECK NO:	4201		
	NAME:	MONTGOMERY, NORMAN PO BOX 941 COOLIDGE AZ 85128-0018 US		

REMARKS

This receipt was generated by the automated BLM Collections and Billing System and is a paper representation of a portion of the official electronic record contained therein.

414304

FOR COUNTY RECORDER'S USE

Total due BLM \$ 7905.00

Rec 3928439

Ek

2. The maintenance fee for the following claim(s) applies to the assessment year _____.

CLAIM NAME	BLM SERIAL NO.	ACRES IN CLAIM	PAYMENT DUE TO THE BLM (See Instructions on Page 2)
BRENZEE	83517		1240
ESPERANZA	83518		1240
HORSE SHOE	83519		310
ARIZONA	83520		155
NUGET	83521		310
BELL	83522		310
SUNSHOT	83523		1240
HARD NOT	62617+		1240

Use a separate sheet for additional claim names, serial numbers, and claimant names and addresses.

(Continued on page 2)

ma numbers, and claimant names and addresses.

RECEIVED
TLM AZ STATE OFFICE
AUG 22 2017
BY: *[Signature]*

UNITED STATES
DEPARTMENT OF THE INTERIOR
BUREAU OF LAND MANAGEMENT
**MAINTENANCE FEE PAYMENT FORM
FOR PLACER MINING CLAIMS**

Remitter Name: _____

Mailing Address: _____

City, State, Zip: _____

☐ Check here if this is a change of address.

FOR COUNTY RECORDER'S USE

No. of claims _____

Total due BLM \$ _____

1. The maintenance fee may be paid by cash, check, money order, Bureau of Land Management (BLM) Declining Deposit Account, or credit card (VISA, American Express, Discover, or MasterCard). Payments must be remitted to the BLM State Office where your claim or site is recorded and received on or before September 1. If the payment is mailed, the envelope must be postmarked by a bona fide delivery service on or before September 1 and received at the proper BLM State Office within 15 calendar days after the due date. Payments may also be made by telephone using a credit card. A complete listing of BLM State Offices with their addresses and phone numbers can be found at <http://www.blm.gov>.
2. The maintenance fee for the following claim(s) applies to the assessment year _____.

CLAIM NAME	BLM SERIAL NO.	ACRES IN CLAIM	PAYMENT DUE TO THE BLM (See Instructions on Page 2)
Pajaro	400019		155
Reymont	400020		155
Sting # 4	400021		155
Wattsonville	400022		155
Apitos	414304		155
Capitolz	414305		155
Minamian	414306		155
Sting # 1	414307		155
Sting # 2	414308		155
Sting # 3	414309		155

Use a separate sheet for additional claim names, serial numbers, and claimant names and addresses.

May be used with the following forms for listing additional mining claims:

- ☐ Affidavit of Performance of Annual Work
- ☐ Maintenance Fee Payment
- ☐ Notice of Intent to Hold Mining Claims
- ☐ Notice of Non-Liability for Labor and Materials Furnished
- ☐ Quit claim Deed

RECEIVED
BLM AZ STATE OFFICE
2017 AUG -9 A 4:59
PHOENIX, ARIZONA

[illegible]

Form MCF114
Revised July 2014

This form is available from the **Arizona Geological Survey** and may be reproduced.

United States Department of the Interior
Bureau of Land Management
DIV OF LANDS, MINRLS & ENERGY
ONE N CENTRAL AVE
PHOENIX, AZ 85004 -4427
Phone: 602-417-9200

Receipt

No: 3928439

Transaction #: 4037993	
Date of Transaction: 08/09/2017	
CUSTOMER:	
	NORMAN MONTGOMERY PO BOX 941 COOLIDGE, AZ 85128-0018 US

LINE #	QTY	DESCRIPTION	REMARKS	UNIT PRICE	TOTAL
1	1.00	LOCATABLE MINERALS / MINING CLAIMS- NOT NEW-UNADJUD, ONE AUTH NO. ONLY / MINING CLAIM MONEY RECEIVED CASES: AMC83517/\$7905.00	2018 MAINT (20)	- n/a -	7905.00
TOTAL:					\$7,905.00

PAYMENT INFORMATION				
1	AMOUNT:	7905.00	POSTMARKED:	N/A
	TYPE:	CHECK	RECEIVED:	08/09/2017
	CHECK NO:	3912		
	NAME:	GILA ROCK PRODUCTS LLC PO BOX 941 COOLIDGE AZ 85128-0018 US		

REMARKS

This receipt was generated by the automated BLM Collections and Billing System and is a paper representation of a portion of the official electronic record contained therein.

UNITED STATES
DEPARTMENT OF THE INTERIOR
BUREAU OF LAND MANAGEMENT
**MAINTENANCE FEE PAYMENT FORM
FOR PLACER MINING CLAIMS**

83517
62617
400019
414304

RECEIVED
BLM AZ STATE OFFICE
2016 AUG - 8 A 11:14
PHOENIX, ARIZONA

Remitter Name: NOAMAN MONTGOMERY

Mailing Address: PO BOX 941

City, State, Zip: COOLIDGE, AZ 85128

☐ Check here if this is a change of address.

FOR COUNTY RECORDER'S USE

No. of claims 8
Total due BLM \$ _____

- The maintenance fee may be paid by cash, check, money order, Bureau of Land Management (BLM) Declining Deposit Account, or credit card (VISA, American Express, Discover, or MasterCard). Payments must be remitted to the BLM State Office where your claim or site is recorded and received on or before September 1. If the payment is mailed, the envelope must be postmarked by a bona fide delivery service on or before September 1 and received at the proper BLM State Office within 15 calendar days after the due date. Payments may also be made by telephone using a credit card. A complete listing of BLM State Offices with their addresses and phone numbers can be found at <http://www.blm.gov>.
- The maintenance fee for the following claim(s) applies to the assessment year _____.

CLAIM NAME	BLM SERIAL NO.	ACRES IN CLAIM	PAYMENT DUE TO THE BLM (See Instructions on Page 2)
BONANZA	83517		1240
ESPERANZA	83518		1240
HORSE SHOE	83519		310
ARIZONA	83520		155
NUGET	83521		310
BELL	83522		310
SHUR SHOT	83523		1240
HAND NUT	62617		1240

Use a separate sheet for additional claim names, serial numbers, and claimant names and addresses.

#3623334

(Continued on page 2)

ENTERED
AUG 10 2016
BY: rm

UNITED STATES
DEPARTMENT OF THE INTERIOR
BUREAU OF LAND MANAGEMENT
**MAINTENANCE FEE PAYMENT FORM FOR
LODE CLAIMS, MILL SITES, AND TUNNEL SITES**

RECEIVED
BLM AZ STATE OFFICE
2016 AUG - 8 A 11:14
PHOENIX, ARIZONA

Remitter Name: NOAMAR MONTGOMERY

Mailing Address: PO BOX 941

City, State, Zip: COOLIDGE, AZ 85128

☐ Check here if this is a change of address.

FOR COUNTY RECORDER'S USE

No. of claims/sites 12
x \$155 per claim/site
Total due BLM \$ 0

1. The maintenance fee may be paid by cash, check, money order, Bureau of Land Management (BLM) Declining Deposit Account, or credit card (VISA, American Express, Discover, or MasterCard). Payments must be remitted to the BLM State Office where your claim or site is recorded and received on or before September 1. If the payment is mailed, the envelope must be postmarked by a bona fide delivery service on or before September 1 and received at the proper BLM State Office within 15 calendar days after the due date. Payments may also be made by telephone using a credit card. A complete listing of BLM State Offices with their addresses and phone numbers can be found at <http://www.blm.gov>.
2. The maintenance fee for the following claim(s)/site(s) applies to the assessment year _____.

CLAIM/SITE NAME	BLM SERIAL NO.
<u>Pajaro</u>	<u>400019</u>
<u>Reymont</u>	<u>400020</u>
<u>Sting #6</u>	<u>400021</u>
<u>Wattsonville</u>	<u>400022</u>
<u>Aptos</u>	<u>414304</u>
<u>Capitol</u>	<u>414305</u>
<u>Miramar</u>	<u>414306</u>
<u>Sting #1</u>	<u>414307</u>
<u>Sting #2</u>	<u>414308</u>
<u>Sting #3</u>	<u>414309</u>

Use a separate sheet for additional claim/site names, serial numbers, and claimant names and addresses.

UNITED STATES
DEPARTMENT OF THE INTERIOR
BUREAU OF LAND MANAGEMENT
**MAINTENANCE FEE PAYMENT FORM FOR
LODE CLAIMS, MILL SITES, AND TUNNEL SITES**

RECEIVED
BLM AZ STATE OFFICE
2018 AUG - 8 A 11: 14
PHOENIX, ARIZONA

Remitter Name: Norman Montgomery

Mailing Address: PO Box 941

City, State, Zip: Coolidge, AZ 85128

☐ Check here if this is a change of address.

FOR COUNTY RECORDER'S USE

No. of claims/sites _____
x \$155 per claim/site
Total due BLM \$ 0

1. The maintenance fee may be paid by cash, check, money order, Bureau of Land Management (BLM) Declining Deposit Account, or credit card (VISA, American Express, Discover, or MasterCard). Payments must be remitted to the BLM State Office where your claim or site is recorded and received on or before September 1. If the payment is mailed, the envelope must be postmarked by a bona fide delivery service on or before September 1 and received at the proper BLM State Office within 15 calendar days after the due date. Payments may also be made by telephone using a credit card. A complete listing of BLM State Offices with their addresses and phone numbers can be found at <http://www.blm.gov>.
2. The maintenance fee for the following claim(s)/site(s) applies to the assessment year _____.

CLAIM/SITE NAME	BLM SERIAL NO.
<u>Sting # 4</u>	<u>414310</u>
<u>Sting # 5</u>	<u>414311</u>

Use a separate sheet for additional claim/site names, serial numbers, and claimant names and addresses.

**DEPARTMENT OF THE INTERIOR
BUREAU OF LAND MANAGEMENT
MINING CLAIMS
(MASS) Serial Register Page**

RunDate/Time:08/08/16 11:08 AM

Page: 1 of 14

01 10-21-1976;090STAT0090;43USC1744

Case Type 384201: PLACER CLAIM

Commodity:

Claim Name: BONANZA

Case Disposition: ACTIVE

Required Maintenance Fee: \$1,240.00

Total Acres

160.000

Serial Number

AMC83517

Lead File Number

AMC83517

Name & Address

MONTGOMERY NORMAN

PO BOX 941

COOLIDGE, AZ 85128-0018

Int Rel

CLAIMANT

County/State

PIMA County, AZ

District

PHOENIX DO

Mer Twp Rng Sec Subdivision

14 0150S 0020E 002 NE,NW,SW,SE

Act Date	Code	Action Text	Action Remarks	Receipt Number
----------	------	-------------	----------------	----------------

02/16/1900	403	LOCATION DATE		
------------	-----	---------------	--	--

10/19/1979	395	RECORDATION NOTICE RECD		
------------	-----	-------------------------	--	--

08/06/2015	782	MAINTENANCE FEE PAYMENT	2016;\$1240	3360069
------------	-----	-------------------------	-------------	---------

07/28/2014	782	MAINTENANCE FEE PAYMENT	2015;\$1240	3086180
------------	-----	-------------------------	-------------	---------

07/31/2013	682	MAINTENANCE FEE/\$140	2014;\$1120	2843684
------------	-----	-----------------------	-------------	---------

03/07/2012	682	MAINTENANCE FEE/\$140	2013;\$140	2529188
------------	-----	-----------------------	------------	---------

06/06/2011	682	MAINTENANCE FEE/\$140	2012	2357426
------------	-----	-----------------------	------	---------

04/20/2010	682	MAINTENANCE FEE/\$140	2011	2121090
------------	-----	-----------------------	------	---------

06/15/2009	582	MAINTENANCE FEE/\$125	2010	1940063
------------	-----	-----------------------	------	---------

08/05/2008	582	MAINTENANCE FEE/\$125	2009	1754264
------------	-----	-----------------------	------	---------

08/07/2007	582	MAINTENANCE FEE/\$125	2008	1538567
------------	-----	-----------------------	------	---------

08/08/2006	582	MAINTENANCE FEE/\$125	2007	1329804
------------	-----	-----------------------	------	---------

07/15/2005	582	MAINTENANCE FEE/\$125	2006	1110547
------------	-----	-----------------------	------	---------

08/11/2004	582	MAINTENANCE FEE/\$125	2005	926222
------------	-----	-----------------------	------	--------

08/14/2003	482	MAINTENANCE FEE/\$100	2004	729853
------------	-----	-----------------------	------	--------

05/30/2002	482	MAINTENANCE FEE/\$100	2003	501572
------------	-----	-----------------------	------	--------

06/21/1999	482	MAINTENANCE FEE/\$100	2002	
------------	-----	-----------------------	------	--

06/21/1999	482	MAINTENANCE FEE/\$100	2001	
------------	-----	-----------------------	------	--

07/10/1998	482	MAINTENANCE FEE/\$100	2000	
------------	-----	-----------------------	------	--

08/27/1996	482	MAINTENANCE FEE/\$100	1999	
------------	-----	-----------------------	------	--

08/27/1996	482	MAINTENANCE FEE/\$100	1998	
------------	-----	-----------------------	------	--

07/20/1995	482	MAINTENANCE FEE/\$100	1997	
------------	-----	-----------------------	------	--

07/20/1995	482	MAINTENANCE FEE/\$100	1996	
------------	-----	-----------------------	------	--

04/06/1994	482	MAINTENANCE FEE/\$100	1995	
------------	-----	-----------------------	------	--

07/29/1993	482	MAINTENANCE FEE/\$100	1994	
------------	-----	-----------------------	------	--

07/29/1993	482	MAINTENANCE FEE/\$100	1993;RECEIPT 1900707	
------------	-----	-----------------------	----------------------	--

11/25/1992	480	EVID OF ASSMT FILED	1992	
------------	-----	---------------------	------	--

03/20/2013	379	REFUND AUTHORIZED	\$700 OVRPMT 2013 MF	2634590
------------	-----	-------------------	----------------------	---------

08/27/2012	685	ADDL MAINTENANCE FEE	2013;\$980	2641118
------------	-----	----------------------	------------	---------

RECEIVED
BLM AZ STATE OFFICE
2016 AUG - 8 A 11: 14
PHOENIX, ARIZONA

**NO WARRANTY IS MADE BY BLM
FOR USE OF THE DATA FOR
PURPOSES NOT INTENDED BY BLM**

**DEPARTMENT OF THE INTERIOR
BUREAU OF LAND MANAGEMENT
MINING CLAIMS
(MASS) Serial Register Page**

RunDate/Time:08/08/16 11:08 AM

Page: 2 of 14

07/31/2009	399	CURABLE \$15 MAINT FEE	2010	1969319
10/22/2004	379	REFUND AUTHORIZED	\$800.00;OVERPAYMENT	810717
04/06/1994	396	TRF OF INTEREST FILED	ROCKOWITZ MELVIN	
04/06/1994	396	TRF OF INTEREST FILED	HARRIS DENNIS	
04/06/1994	396	TRF OF INTEREST FILED	STOUFER PHILIP	
10/06/1987	669	LAND STATUS CHECKED		
10/07/1980	396	TRF OF INTEREST FILED	TURNBULL JACK R	
10/19/1979	500	MAP IN LEAD FILE	AMC83517;	
10/19/1979	501	ACCT ADV IN LEAD FILE	AMC83517;	

Line Nr **Remarks**

RECEIVED
BLM AZ STATE OFFICE
2016 AUG - 8 A 11: 14
PHOENIX, ARIZONA

**DEPARTMENT OF THE INTERIOR
BUREAU OF LAND MANAGEMENT
MINING CLAIMS
(MASS) Serial Register Page**

RunDate/Time:08/08/16 11:08 AM

Page: 3 of 14

01 10-21-1976;090STAT0090;43USC1744
Case Type 384201: PLACER CLAIM
Commodity:
Claim Name: ESPERANZA
Case Disposition: ACTIVE
Required Maintenance Fee: \$1,240.00

Total Acres
160.000

Serial Number
AMC83518
Lead File Number
AMC83517

Name & Address	Int Rel
HARRIS DENNIS PO BOX 941 COOLIDGE, AZ 85128-0018	CLAIMANT
MONTGOMERY NORMAN PO BOX 941 COOLIDGE, AZ 85128-0018	CLAIMANT

County/State	District
PIMA County, AZ	PHOENIX DO

Mer Twp	Rng	Sec	Subdivision
14	0150S	0020E	011 NE, SE
14	0150S	0020E	012 NW, SW

Act Date	Code	Action Text	Action Remarks	Receipt Number
01/01/1900	403	LOCATION DATE		
10/19/1979	395	RECORDATION NOTICE RECD		
08/06/2015	782	MAINTENANCE FEE PAYMENT	2016;\$1240	3360069
07/28/2014	782	MAINTENANCE FEE PAYMENT	2015;\$1240	3086180
07/31/2013	682	MAINTENANCE FEE/\$140	2014;\$1120	2843684
03/07/2012	682	MAINTENANCE FEE/\$140	2013;\$140	2529188
06/06/2011	682	MAINTENANCE FEE/\$140	2012	2357426
04/20/2010	682	MAINTENANCE FEE/\$140	2011	2121090
06/15/2009	582	MAINTENANCE FEE/\$125	2010	1940063
08/05/2008	582	MAINTENANCE FEE/\$125	2009	1754264
08/07/2007	582	MAINTENANCE FEE/\$125	2008	1538567
08/08/2006	582	MAINTENANCE FEE/\$125	2007	1329804
07/15/2005	582	MAINTENANCE FEE/\$125	2006	1110547
08/11/2004	582	MAINTENANCE FEE/\$125	2005	926222
08/14/2003	482	MAINTENANCE FEE/\$100	2004	729853
05/30/2002	482	MAINTENANCE FEE/\$100	2003	501572
06/21/1999	482	MAINTENANCE FEE/\$100	2002	
06/21/1999	482	MAINTENANCE FEE/\$100	2001	
07/10/1998	482	MAINTENANCE FEE/\$100	2000	
08/27/1996	482	MAINTENANCE FEE/\$100	1999	
08/27/1996	482	MAINTENANCE FEE/\$100	1998	
07/20/1995	482	MAINTENANCE FEE/\$100	1997	
07/20/1995	482	MAINTENANCE FEE/\$100	1996	
04/06/1994	482	MAINTENANCE FEE/\$100	1995	
07/29/1993	482	MAINTENANCE FEE/\$100	1994	
07/29/1993	482	MAINTENANCE FEE/\$100	1993;RECEIPT 1900707	
11/25/1992	480	EVID OF ASSMT FILED	1992	
08/27/2012	685	ADDL MAINTENANCE FEE	2013;\$980	2641118
07/31/2009	399	CURABLE \$15 MAINT FEE	2010	1969319

RECEIVED
BLM AZ STATE OFFICE
2016 AUG - 8 A 11:14
PHOENIX, ARIZONA

NO WARRANTY IS MADE BY BLM
FOR USE OF THE DATA FOR
PURPOSES NOT INTENDED BY BLM

DEPARTMENT OF THE INTERIOR
BUREAU OF LAND MANAGEMENT
MINING CLAIMS
(MASS) Serial Register Page

RunDate/Time:08/08/16 11:08 AM

Page: 4 of 14

06/21/1999	113	ADDITIONAL INFO RECEIVED	RECEIPT 2480377
07/10/1998	113	ADDITIONAL INFO RECEIVED	RECEIPT 2389044
08/27/1996	113	ADDITIONAL INFO RECEIVED	RECEIPT 2263477
07/20/1995	113	ADDITIONAL INFO RECEIVED	RECEIPT 2147274
04/06/1994	396	TRF OF INTEREST FILED	ROCKOWITZ MELVIN
04/06/1994	396	TRF OF INTEREST FILED	HARRIS DENNIS
04/06/1994	396	TRF OF INTEREST FILED	STOUFER PHILIP
10/06/1987	669	LAND STATUS CHECKED	
10/07/1980	396	TRF OF INTEREST FILED	TURNBULL JACK R
10/19/1979	500	MAP IN LEAD FILE	83517
10/19/1979	501	ACCT ADV IN LEAD FILE	83517
03/05/1900	404	COUNTY RECORDATION	0;0;0

Line Nr Remarks

RECEIVED
BLM AZ STATE OFFICE
2016 AUG - 8 A 11: 14
PHOENIX, ARIZONA

DEPARTMENT OF THE INTERIOR
BLM BUREAU OF LAND MANAGEMENT
MINING CLAIMS
(MASS) Serial Register Page

RunDate/Time:08/08/16 11:08 AM

Page: 5 of 14

01 10-21-1976;090STAT0090;43USC1744

Case Type 384201: PLACER CLAIM

Commodity:

Claim Name: HORSE SHOE

Case Disposition: ACTIVE

Required Maintenance Fee: \$310.00

Total Acres

20.600

Serial Number

AMC83519

Lead File Number

AMC83517

Name & Address

MONTGOMERY NORMAN

PO BOX 941

COOLIDGE, AZ 85128-0018

Int Rel

CLAIMANT

County/State

PIMA County, AZ

District

PHOENIX DO

Mer Twp Rng Sec Subdivision

14 0150S 0020E 011 SE

14 0150S 0020E 014 NE

Act Date	Code	Action Text	Action Remarks	Receipt Number
05/19/1900	403	LOCATION DATE		
10/19/1979	395	RECORDATION NOTICE RECD		
08/06/2015	782	MAINTENANCE FEE PAYMENT	2016;\$310	3360069
07/28/2014	782	MAINTENANCE FEE PAYMENT	2015;\$310	3086180
07/31/2013	682	MAINTENANCE FEE/\$140	2014;\$280	2843684
08/20/2012	682	MAINTENANCE FEE/\$140	2013;\$280	2634590
06/06/2011	682	MAINTENANCE FEE/\$140	2012	2357426
04/20/2010	682	MAINTENANCE FEE/\$140	2011	2121090
06/15/2009	582	MAINTENANCE FEE/\$125	2010	1940063
08/05/2008	582	MAINTENANCE FEE/\$125	2009	1754264
08/07/2007	582	MAINTENANCE FEE/\$125	2008	1538567
08/08/2006	582	MAINTENANCE FEE/\$125	2007	1329804
07/15/2005	582	MAINTENANCE FEE/\$125	2006	1110547
08/11/2004	582	MAINTENANCE FEE/\$125	2005	926222
08/14/2003	482	MAINTENANCE FEE/\$100	2004	729853
05/30/2002	482	MAINTENANCE FEE/\$100	2003	501572
06/21/1999	482	MAINTENANCE FEE/\$100	2002	
06/21/1999	482	MAINTENANCE FEE/\$100	2001	
07/10/1998	482	MAINTENANCE FEE/\$100	2000	
08/27/1996	482	MAINTENANCE FEE/\$100	1999	
08/27/1996	482	MAINTENANCE FEE/\$100	1998	
07/20/1995	482	MAINTENANCE FEE/\$100	1997	
07/20/1995	482	MAINTENANCE FEE/\$100	1996	
04/06/1994	482	MAINTENANCE FEE/\$100	1995	
07/29/1993	482	MAINTENANCE FEE/\$100	1994	
07/29/1993	482	MAINTENANCE FEE/\$100	1993;RECEIPT 1900707	
11/25/1992	480	EVID OF ASSMT FILED	1992	
07/31/2009	399	CURABLE \$15 MAINT FEE	2010	1969319
06/21/1999	113	ADDITIONAL INFO RECEIVED	RECEIPT 2480377	

RECEIVED
 BLM AZ STATE OFFICE
 2016 AUG - 8 A 11: 14
 PHOENIX, ARIZONA

NO WARRANTY IS MADE BY BLM
 FOR USE OF THE DATA FOR
 PURPOSES NOT INTENDED BY BLM

**DEPARTMENT OF THE INTERIOR
BUREAU OF LAND MANAGEMENT
MINING CLAIMS
(MASS) Serial Register Page**

RunDate/Time:08/08/16 11:08 AM

Page: 6 of 14

07/10/1998	113	ADDITIONAL INFO RECEIVED	RECEIPT 2389044
08/27/1996	113	ADDITIONAL INFO RECEIVED	RECEIPT 2263477
07/20/1995	113	ADDITIONAL INFO RECEIVED	RECEIPT 2147274
04/06/1994	396	TRF OF INTEREST FILED	ROCKOWITZ MELVIN
04/06/1994	396	TRF OF INTEREST FILED	STOUFER PHILIP
04/06/1994	396	TRF OF INTEREST FILED	HARRIS DENNIS
10/06/1987	669	LAND STATUS CHECKED	
10/07/1980	396	TRF OF INTEREST FILED	TURNBULL JACK R
10/19/1979	500	MAP IN LEAD FILE	83517
10/19/1979	501	ACCT ADV IN LEAD FILE	83517
06/18/1900	404	COUNTY RECORDATION	0;0;0

Line Nr Remarks

RECEIVED
BLM AZ STATE OFFICE
2016 AUG - 8 A 11: 14
PHOENIX, ARIZONA

**DEPARTMENT OF THE INTERIOR
BUREAU OF LAND MANAGEMENT
MINING CLAIMS
(MASS) Serial Register Page**

RunDate/Time:08/08/16 11:08 AM

Page: 7 of 14

01 10-21-1976;090STAT0090;43USC1744

Case Type 384201: PLACER CLAIM

Commodity:

Claim Name: ARIZONA

Case Disposition: ACTIVE

Required Maintenance Fee: \$155.00

Total Acres

20.000

Serial Number

AMC83520

Lead File Number

AMC83517

Name & Address

MONTGOMERY NORMAN

PO BOX 941

COOLIDGE, AZ 85128-0018

Int Rel

CLAIMANT

County/State

PIMA County, AZ

District

PHOENIX DO

Mer Twp Rng Sec Subdivision

14 0150S 0020E 012 SW

14 0150S 0020E 013 NW

Act Date	Code	Action Text	Action Remarks	Receipt Number
07/31/1897	403	LOCATION DATE		
10/19/1979	395	RECORDATION NOTICE RECD		
08/06/2015	782	MAINTENANCE FEE PAYMENT	2016;\$155	3360069
07/28/2014	782	MAINTENANCE FEE PAYMENT	2015;\$155	3086180
07/31/2013	682	MAINTENANCE FEE/\$140	2014;\$140	2843684
03/07/2012	682	MAINTENANCE FEE/\$140	2013;\$140	2529188
06/06/2011	682	MAINTENANCE FEE/\$140	2012	2357426
04/20/2010	682	MAINTENANCE FEE/\$140	2011	2121090
06/15/2009	582	MAINTENANCE FEE/\$125	2010	1940063
08/05/2008	582	MAINTENANCE FEE/\$125	2009	1754264
08/07/2007	582	MAINTENANCE FEE/\$125	2008	1538567
08/08/2006	582	MAINTENANCE FEE/\$125	2007	1329804
07/15/2005	582	MAINTENANCE FEE/\$125	2006	1110547
08/11/2004	582	MAINTENANCE FEE/\$125	2005	926222
08/14/2003	482	MAINTENANCE FEE/\$100	2004	729853
05/30/2002	482	MAINTENANCE FEE/\$100	2003	501572
06/21/1999	482	MAINTENANCE FEE/\$100	2002	
06/21/1999	482	MAINTENANCE FEE/\$100	2001	
07/10/1998	482	MAINTENANCE FEE/\$100	2000	
08/27/1996	482	MAINTENANCE FEE/\$100	1999	
08/27/1996	482	MAINTENANCE FEE/\$100	1998	
07/20/1995	482	MAINTENANCE FEE/\$100	1997	
07/20/1995	482	MAINTENANCE FEE/\$100	1996	
04/06/1994	482	MAINTENANCE FEE/\$100	1995	
07/29/1993	482	MAINTENANCE FEE/\$100	1994	
07/29/1993	482	MAINTENANCE FEE/\$100	1993;RECEIPT 1900707	
11/25/1992	480	EVID OF ASSMT FILED	1992	
07/31/2009	399	CURABLE \$15 MAINT FEE	2010	1969319
06/21/1999	113	ADDITIONAL INFO RECEIVED	RECEIPT 2480377	

PHOENIX, ARIZONA

2016 AUG - 8 A 11: 14

RECEIVED
BLM AZ STATE OFFICE

NO WARRANTY IS MADE BY BLM
FOR USE OF THE DATA FOR
PURPOSES NOT INTENDED BY BLM

DEPARTMENT OF THE INTERIOR
BUREAU OF LAND MANAGEMENT
MINING CLAIMS
(MASS) Serial Register Page

RunDate/Time:08/08/16 11:08 AM

Page: 8 of 14

07/10/1998	113	ADDITIONAL INFO RECEIVED	RECEIPT 2389044
08/27/1996	113	ADDITIONAL INFO RECEIVED	RECEIPT 2263477
07/20/1995	113	ADDITIONAL INFO RECEIVED	RECEIPT 2147274
04/06/1994	396	TRF OF INTEREST FILED	HARRIS DENNIS
04/06/1994	396	TRF OF INTEREST FILED	STOUFER PHILIP
04/06/1994	396	TRF OF INTEREST FILED	ROCKOWITZ MELVIN
10/06/1987	669	LAND STATUS CHECKED	
10/07/1980	396	TRF OF INTEREST FILED	TURNBULL JACK R
10/19/1979	500	MAP IN LEAD FILE	83517
10/19/1979	501	ACCT ADV IN LEAD FILE	83517
07/31/1897	404	COUNTY RECORDATION	0;000;000

Line Nr **Remarks**

RECEIVED
BLM AZ STATE OFFICE
2016 AUG - 8 A 11:14
PHOENIX, ARIZONA

**DEPARTMENT OF THE INTERIOR
BUREAU OF LAND MANAGEMENT
MINING CLAIMS
(MASS) Serial Register Page**

RunDate/Time:08/08/16 11:08 AM

Page: 9 of 14

01 10-21-1976;090STAT0090;43USC1744

Case Type 384201: PLACER CLAIM

Commodity:

Claim Name: NUGET

Case Disposition: ACTIVE

Required Maintenance Fee: \$310.00

Total Acres

20.660

Serial Number

AMC83521

Lead File Number

AMC83517

Name & Address

MONTGOMERY NORMAN

PO BOX 941

COOLIDGE, AZ 85128-0018

Int Rel

CLAIMANT

County/State

PIMA County, AZ

District

PHOENIX DO

Mer Twp Rng Sec Subdivision

14 0150S 0020E 014 NE

Act Date	Code	Action Text	Action Remarks	Receipt Number
08/13/1892	403	LOCATION DATE		
10/19/1979	395	RECORDATION NOTICE RECD		
08/06/2015	782	MAINTENANCE FEE PAYMENT	2016;\$310	3360069
07/28/2014	782	MAINTENANCE FEE PAYMENT	2015;\$310	3086180
07/31/2013	682	MAINTENANCE FEE/\$140	2014;\$280	2843684
03/07/2012	682	MAINTENANCE FEE/\$140	2013;\$140	2529188
06/06/2011	682	MAINTENANCE FEE/\$140	2012	2357426
04/20/2010	682	MAINTENANCE FEE/\$140	2011	2121090
06/15/2009	582	MAINTENANCE FEE/\$125	2010	1940063
08/05/2008	582	MAINTENANCE FEE/\$125	2009	1754264
08/07/2007	582	MAINTENANCE FEE/\$125	2008	1538567
08/08/2006	582	MAINTENANCE FEE/\$125	2007	1329804
07/15/2005	582	MAINTENANCE FEE/\$125	2006	1110547
08/11/2004	582	MAINTENANCE FEE/\$125	2005	926222
08/14/2003	482	MAINTENANCE FEE/\$100	2004	729853
05/30/2002	482	MAINTENANCE FEE/\$100	2003	501572
06/21/1999	482	MAINTENANCE FEE/\$100	2002	
06/21/1999	482	MAINTENANCE FEE/\$100	2001	
07/10/1998	482	MAINTENANCE FEE/\$100	2000	
08/27/1996	482	MAINTENANCE FEE/\$100	1999	
08/27/1996	482	MAINTENANCE FEE/\$100	1998	
07/20/1995	482	MAINTENANCE FEE/\$100	1997	
07/20/1995	482	MAINTENANCE FEE/\$100	1996	
04/06/1994	482	MAINTENANCE FEE/\$100	1995	
07/29/1993	482	MAINTENANCE FEE/\$100	1994	
07/29/1993	482	MAINTENANCE FEE/\$100	1993;RECEIPT 1900707	
11/25/1992	480	EVID OF ASSMT FILED	1992	
08/27/2012	685	ADDL MAINTENANCE FEE	2013;\$140	2641118
07/31/2009	399	CURABLE \$15 MAINT FEE	2010	1969319

RECEIVED
BLM AZ STATE OFFICE
2016 AUG - 8 A 11: 14
PHOENIX, ARIZONA

NO WARRANTY IS MADE BY BLM
FOR USE OF THE DATA FOR
PURPOSES NOT INTENDED BY BLM

DEPARTMENT OF THE INTERIOR
BUREAU OF LAND MANAGEMENT
MINING CLAIMS
(MASS) Serial Register Page

RunDate/Time:08/08/16 11:08 AM

Page: 10 of 14

04/06/1994	396	TRF OF INTEREST FILED	ROCKOWITZ MELVIN
04/06/1994	396	TRF OF INTEREST FILED	HARRIS DENNIS
04/06/1994	396	TRF OF INTEREST FILED	STOUFER PHILIP
10/06/1987	669	LAND STATUS CHECKED	
10/07/1980	396	TRF OF INTEREST FILED	TURNBULL JACK R
10/19/1979	500	MAP IN LEAD FILE	83517
10/19/1979	501	ACCT ADV IN LEAD FILE	83517
10/12/1892	404	COUNTY RECORDATION	0;0;0

Line Nr Remarks

RECEIVED
BLM AZ STATE OFFICE
2016 AUG - 8 A 11: 14
PHOENIX, ARIZONA

**DEPARTMENT OF THE INTERIOR
BUREAU OF LAND MANAGEMENT
MINING CLAIMS
(MASS) Serial Register Page**

RunDate/Time:08/08/16 11:08 AM

Page: 11 of 14

01 10-21-1976;090STAT0090;43USC1744

Case Type 384201: PLACER CLAIM

Commodity:

Claim Name: BELL

Case Disposition: ACTIVE

Required Maintenance Fee: \$310.00

Total Acres

20.660

Serial Number

AMC83522

Lead File Number

AMC83517

Name & Address

MONTGOMERY NORMAN

PO BOX 941

COOLIDGE, AZ 85128-0018

Int Rel

CLAIMANT

County/State

PIMA County, AZ

District

PHOENIX DO

Mer Twp Rng Sec Subdivision

14 0150S 0020E 011 SE

14 0150S 0020E 014 NE

Act Date	Code	Action Text	Action Remarks	Receipt Number
08/13/1892	403	LOCATION DATE		
10/19/1979	395	RECORDATION NOTICE RECD		
08/06/2015	782	MAINTENANCE FEE PAYMENT	2016;\$310	3360069
07/28/2014	782	MAINTENANCE FEE PAYMENT	2015;\$310	3086180
07/31/2013	682	MAINTENANCE FEE/\$140	2014;\$280	2843684
03/07/2012	682	MAINTENANCE FEE/\$140	2013;\$140	2529188
06/06/2011	682	MAINTENANCE FEE/\$140	2012	2357426
04/20/2010	682	MAINTENANCE FEE/\$140	2011	2121090
06/15/2009	582	MAINTENANCE FEE/\$125	2010	1940063
08/05/2008	582	MAINTENANCE FEE/\$125	2009	1754264
08/07/2007	582	MAINTENANCE FEE/\$125	2008	1538567
08/08/2006	582	MAINTENANCE FEE/\$125	2007	1329804
07/15/2005	582	MAINTENANCE FEE/\$125	2006	1110547
08/11/2004	582	MAINTENANCE FEE/\$125	2005	926222
08/14/2003	482	MAINTENANCE FEE/\$100	2004	729853
05/30/2002	482	MAINTENANCE FEE/\$100	2003	501572
06/21/1999	482	MAINTENANCE FEE/\$100	2002	
06/21/1999	482	MAINTENANCE FEE/\$100	2001	
07/10/1998	482	MAINTENANCE FEE/\$100	2000	
08/27/1996	482	MAINTENANCE FEE/\$100	1999	
08/27/1996	482	MAINTENANCE FEE/\$100	1998	
07/20/1995	482	MAINTENANCE FEE/\$100	1997	
07/20/1995	482	MAINTENANCE FEE/\$100	1996	
04/06/1994	482	MAINTENANCE FEE/\$100	1995	
07/29/1993	482	MAINTENANCE FEE/\$100	1994	
07/29/1993	482	MAINTENANCE FEE/\$100	1993;RECEIPT 1900707	
11/25/1992	480	EVID OF ASSMT FILED	1992	
08/27/2012	685	ADDL MAINTENANCE FEE	2013;\$140	2634590
07/31/2009	399	CURABLE \$15 MAINT FEE	2010	1969319

RECEIVED
BLM AZ STATE OFFICE
2016 AUG -8 A 11: 14
PHOENIX, ARIZONA

NO WARRANTY IS MADE BY BLM
FOR USE OF THE DATA FOR
PURPOSES NOT INTENDED BY BLM

DEPARTMENT OF THE INTERIOR
BUREAU OF LAND MANAGEMENT
MINING CLAIMS
(MASS) Serial Register Page

RunDate/Time:08/08/16 11:08 AM

Page: 12 of 14

06/21/1999	113	ADDITIONAL INFO RECEIVED	RECEIPT 2480377
07/10/1998	113	ADDITIONAL INFO RECEIVED	RECEIPT 2389044
08/27/1996	113	ADDITIONAL INFO RECEIVED	RECEIPT 2263477
07/20/1995	113	ADDITIONAL INFO RECEIVED	RECEIPT 2147274
04/06/1994	396	TRF OF INTEREST FILED	ROCKOWITZ MELVIN
04/06/1994	396	TRF OF INTEREST FILED	HARRIS DENNIS
04/06/1994	396	TRF OF INTEREST FILED	STOUFER PHILIP
10/06/1987	669	LAND STATUS CHECKED	
10/07/1980	396	TRF OF INTEREST FILED	TURNBULL JACK R
10/19/1979	500	MAP IN LEAD FILE	83517
10/19/1979	501	ACCT ADV IN LEAD FILE	83517
10/12/1892	404	COUNTY RECORDATION	0;0;0

Line Nr Remarks

RECEIVED
BLM AZ STATE OFFICE
2016 AUG - 8 A 11:14
PHOENIX, ARIZONA

NO WARRANTY IS MADE BY BLM
FOR USE OF THE DATA FOR
PURPOSES NOT INTENDED BY BLM

**DEPARTMENT OF THE INTERIOR
BUREAU OF LAND MANAGEMENT
MINING CLAIMS
(MASS) Serial Register Page**

RunDate/Time:08/08/16 11:08 AM

Page: 13 of 14

01 10-21-1976;090STAT0090;43USC1744

Case Type 384201: PLACER CLAIM

Commodity:

Claim Name: SHUR SHOT

Case Disposition: ACTIVE

Required Maintenance Fee: \$1,240.00

Total Acres

160.000

Serial Number

AMC83523

Lead File Number

AMC83517

Name & Address

MONTGOMERY NORMAN

PO BOX 941

COOLIDGE, AZ 85128-0018

Int Rel

CLAIMANT

County/State

PIMA County, AZ

District

PHOENIX DO

Mer Twp Rng Sec Subdivision

14	0150S	0020E	001	SW
14	0150S	0020E	002	SE
14	0150S	0020E	011	NE
14	0150S	0020E	012	NW

<u>Act Date</u>	<u>Code</u>	<u>Action Text</u>	<u>Action Remarks</u>	<u>Receipt Number</u>
09/22/1910	403	LOCATION DATE		
10/19/1979	395	RECORDATION NOTICE RECD		
08/06/2015	782	MAINTENANCE FEE PAYMENT	2016;\$1240	3360069
07/28/2014	782	MAINTENANCE FEE PAYMENT	2015;\$1240	3086180
07/31/2013	682	MAINTENANCE FEE/\$140	2014;\$1120	2843684
03/07/2012	682	MAINTENANCE FEE/\$140	2013;\$140	2529188
06/06/2011	682	MAINTENANCE FEE/\$140	2012	2357426
04/20/2010	682	MAINTENANCE FEE/\$140	2011	2121090
06/15/2009	582	MAINTENANCE FEE/\$125	2010	1940063
08/05/2008	582	MAINTENANCE FEE/\$125	2009	1754264
08/07/2007	582	MAINTENANCE FEE/\$125	2008	1538567
08/08/2006	582	MAINTENANCE FEE/\$125	2007	1329804
07/15/2005	582	MAINTENANCE FEE/\$125	2006	1110547
08/11/2004	582	MAINTENANCE FEE/\$125	2005	926222
08/14/2003	482	MAINTENANCE FEE/\$100	2004	729853
05/30/2002	482	MAINTENANCE FEE/\$100	2003	501572
06/21/1999	482	MAINTENANCE FEE/\$100	2002	
06/21/1999	482	MAINTENANCE FEE/\$100	2001	
07/10/1998	482	MAINTENANCE FEE/\$100	2000	
08/27/1996	482	MAINTENANCE FEE/\$100	1999	
08/27/1996	482	MAINTENANCE FEE/\$100	1998	
07/20/1995	482	MAINTENANCE FEE/\$100	1997	
07/20/1995	482	MAINTENANCE FEE/\$100	1996	
04/06/1994	482	MAINTENANCE FEE/\$100	1995	
07/29/1993	482	MAINTENANCE FEE/\$100	1994	
07/29/1993	482	MAINTENANCE FEE/\$100	1993;RECEIPT 1900707	
11/25/1992	480	EVID OF ASSMT FILED	1992	
08/27/2012	685	ADDL MAINTENANCE FEE	2013;\$980	2641118

RECEIVED
BLM AZ STATE OFFICE
2016 AUG - 8 A 11:15
PHOENIX, ARIZONA

NO WARRANTY IS MADE BY BLM
FOR USE OF THE DATA FOR
PURPOSES NOT INTENDED BY BLM

DEPARTMENT OF THE INTERIOR
BUREAU OF LAND MANAGEMENT
MINING CLAIMS
(MASS) Serial Register Page

RunDate/Time:08/08/16 11:08 AM

Page: 14 of 14

07/31/2009	399	CURABLE \$15 MAINT FEE	2010	1969319
06/21/1999	113	ADDITIONAL INFO RECEIVED	RECEIPT 2480377	
07/10/1998	113	ADDITIONAL INFO RECEIVED	RECEIPT 2389044	
08/27/1996	113	ADDITIONAL INFO RECEIVED	RECEIPT 2263477	
07/20/1995	113	ADDITIONAL INFO RECEIVED	RECEIPT 2147274	
04/06/1994	396	TRF OF INTEREST FILED	ROCKOWITZ MELVIN	
04/06/1994	396	TRF OF INTEREST FILED	HARRIS DENNIS	
04/06/1994	396	TRF OF INTEREST FILED	STOUFER PHILIP	
10/06/1987	669	LAND STATUS CHECKED		
10/07/1980	396	TRF OF INTEREST FILED	TURNBULL JACK R	
10/19/1979	500	MAP IN LEAD FILE	83517	
10/19/1979	501	ACCT ADV IN LEAD FILE	83517	
09/28/1910	404	COUNTY RECORDATION	0;0;0	

Line Nr Remarks

RECEIVED
BLM AZ STATE OFFICE
2016 AUG - 8 A 11: 15
PHOENIX, ARIZONA

NO WARRANTY IS MADE BY BLM
FOR USE OF THE DATA FOR
PURPOSES NOT INTENDED BY BLM

**DEPARTMENT OF THE INTERIOR
BUREAU OF LAND MANAGEMENT
MINING CLAIMS
(MASS) Serial Register Page**

Run Date/Time: 08/08/16 12:09 PM

Page 1 c

01 10-21-1976;090STAT0090;43USC1744

Total Acres

Serial Number

Case Type 384201: PLACER CLAIM

160.000

AMC62617

Claim Name: HARD NUT PLCR MNG CL

Lead File Number

Case Disposition: ACTIVE

AMC62617

Required Maintenance Fee: \$1,240.00

Name & Address

Int Rel

MONTGOMERY MITCH

CLAIMANT

PO BOX 941 COOLIDGE, AZ 85128-0018

County / State

District

PIMA County, AZ

PHOENIX DO

Mer Twp Rng Sec

Subdivision

14 0150S 0020E 012

SW

Act Date	Code	Action Text	Action Remarks	Receipt Number
10/14/1910	403	LOCATION DATE		
09/14/1979	395	RECORDATION NOTICE RECD		
08/06/2015	782	MAINTENANCE FEE PAYMENT	2016;\$1240	3360069
07/28/2014	782	MAINTENANCE FEE PAYMENT	2015;\$1240	3086180
07/31/2013	682	MAINTENANCE FEE/\$140	2014;\$1120	2843684
03/07/2012	682	MAINTENANCE FEE/\$140	2013;\$140	2529188
06/06/2011	682	MAINTENANCE FEE/\$140	2012	2357426
04/20/2010	682	MAINTENANCE FEE/\$140	2011	2121090
06/15/2009	582	MAINTENANCE FEE/\$125	2010	1940063
08/05/2008	582	MAINTENANCE FEE/\$125	2009	1754264
08/07/2007	582	MAINTENANCE FEE/\$125	2008	1538567
08/08/2006	582	MAINTENANCE FEE/\$125	2007	1329804
07/15/2005	582	MAINTENANCE FEE/\$125	2006	1110547
08/11/2004	582	MAINTENANCE FEE/\$125	2005	926222
08/14/2003	482	MAINTENANCE FEE/\$100	2004	729853
05/30/2002	482	MAINTENANCE FEE/\$100	2003	501572
06/21/1999	482	MAINTENANCE FEE/\$100	2002	
06/21/1999	482	MAINTENANCE FEE/\$100	2001	
07/10/1998	482	MAINTENANCE FEE/\$100	2000	
08/27/1996	482	MAINTENANCE FEE/\$100	1999	
08/27/1996	482	MAINTENANCE FEE/\$100	1998	
07/20/1995	482	MAINTENANCE FEE/\$100	1997	
07/20/1995	482	MAINTENANCE FEE/\$100	1996	
04/06/1994	482	MAINTENANCE FEE/\$100	1995	
08/16/1993	482	MAINTENANCE FEE/\$100	1994	
08/16/1993	482	MAINTENANCE FEE/\$100	1993;RECEIPT 1900917	
08/16/1993	480	EVID OF ASSMT FILED	1993	

RECEIVED
 BLM AZ STATE OFFICE
 2016 AUG - 8 A 11: 15
 PHOENIX, ARIZONA

DEPARTMENT OF THE INTERIOR
BUREAU OF LAND MANAGEMENT
MINING CLAIMS
(MASS) Serial Register Page

Run Date/Time: 08/08/16 12:09 PM

Page 2 c

08/27/2012	685	ADDL MAINTENANCE FEE	2013;\$980	2641118
07/31/2009	399	CURABLE \$15 MAINT FEE	2010	1969319
04/06/1994	396	TRF OF INTEREST FILED	DUBER JOHN	
04/06/1994	396	TRF OF INTEREST FILED	RUSSELL CARL	
10/06/1987	669	LAND STATUS CHECKED		
09/14/1979	501	ACCT ADV IN LEAD FILE	62617	
10/27/1910	404	COUNTY RECORDATION	0;42;549	

Line Nr Remarks

RECEIVED
BLM AZ STATE OFFICE
2016 AUG - 8 A 11: 15
PHOENIX, ARIZONA

**DEPARTMENT OF THE INTERIOR
BUREAU OF LAND MANAGEMENT
MINING CLAIMS
(MASS) Serial Register Page**

RunDate/Time:08/08/16 11:10 AM

Page: 1 of 4

01 05-10-1872;017STAT0091;30USC26,28,34

Case Type 384101: LODE CLAIM

Commodity:

Claim Name: PAJARO

Case Disposition: ACTIVE

Required Maintenance Fee: \$155.00

Total Acres

20.660

Serial Number

AMC400019

Lead File Number

AMC400019

Name & Address

MONTGOMERY NORMAN

PO BOX 941

COOLIDGE, AZ 85128-0018

Int Rel

CLAIMANT

County/State

PINAL County, AZ

PINAL County, AZ

District

GILA DO

PHOENIX DO

Mer Twp Rng Sec Subdivision

14 0020S 0110E 026 NW,SW

14 0020S 0110E 027 SE

<u>Act Date</u>	<u>Code</u>	<u>Action Text</u>	<u>Action Remarks</u>	<u>Receipt Number</u>
03/22/2010	403	LOCATION DATE		
04/20/2010	395	RECORDATION NOTICE RECD	1	2121065
08/06/2015	782	MAINTENANCE FEE PAYMENT	2016;\$155	3360069
07/28/2014	782	MAINTENANCE FEE PAYMENT	2015;\$155	3086180
07/31/2013	682	MAINTENANCE FEE/\$140	2014;\$140	2843684
03/07/2012	682	MAINTENANCE FEE/\$140	2013;\$140	2529191
06/06/2011	682	MAINTENANCE FEE/\$140	2012	2357435
08/16/2010	682	MAINTENANCE FEE/\$140	2011	2191266
04/20/2010	484	LOCATION YEAR / MAINTENAN	2010	2121065
10/17/2012	379	REFUND AUTHORIZED	\$140;TIMELY WAIVER	2634597
09/03/2010	669	LAND STATUS CHECKED		
04/20/2010	501	ACCT ADV IN LEAD FILE	AMC400019-AMC400022	

Line Nr **Remarks**

RECEIVED
BLM AZ STATE OFFICE
2016 AUG - 8 A 11: 15
PHOENIX, ARIZONA

**DEPARTMENT OF THE INTERIOR
BUREAU OF LAND MANAGEMENT
MINING CLAIMS
(MASS) Serial Register Page**

RunDate/Time:08/08/16 11:10 AM

Page: 2 of 4

01 05-10-1872;017STAT0091;30USC26,28,34

Case Type 384101: LODE CLAIM

Commodity:

Claim Name: REYMERT

Case Disposition: ACTIVE

Required Maintenance Fee: \$155.00

Total Acres

20.660

Serial Number

AMC400020

Lead File Number

AMC400019

Name & Address

MONTGOMERY NORMAN

PO BOX 941

COOLIDGE, AZ 85128-0018

Int Rel

CLAIMANT

County/State

District

PINAL County, AZ

GILA DO

PINAL County, AZ

PHOENIX DO

Mer Twp Rng Sec Subdivision

14 0020S 0110E 022 SE

14 0020S 0110E 027 NE

Act Date	Code	Action Text	Action Remarks	Receipt Number
03/22/2010	403	LOCATION DATE		
04/20/2010	395	RECORDATION NOTICE RECD	1	2121065
08/06/2015	782	MAINTENANCE FEE PAYMENT	2016;\$155	3360069
07/28/2014	782	MAINTENANCE FEE PAYMENT	2015;\$155	3086180
07/31/2013	682	MAINTENANCE FEE/\$140	2014;\$140	2843684
03/07/2012	682	MAINTENANCE FEE/\$140	2013;\$140	2529191
06/06/2011	682	MAINTENANCE FEE/\$140	2012	2357435
08/16/2010	682	MAINTENANCE FEE/\$140	2011	2191266
04/20/2010	484	LOCATION YEAR / MAINTENAN	2010	2121065
10/17/2012	379	REFUND AUTHORIZED	\$140;TIMELY WAIVER	2634597
09/03/2010	669	LAND STATUS CHECKED		
04/20/2010	501	ACCT ADV IN LEAD FILE	AMC400019-AMC400022	

Line Nr Remarks

RECEIVED
 BLM AZ STATE OFFICE
 2016 AUG -8 A 11:15
 PHOENIX, ARIZONA

NO WARRANTY IS MADE BY BLM
FOR USE OF THE DATA FOR
PURPOSES NOT INTENDED BY BLM

**DEPARTMENT OF THE INTERIOR
BUREAU OF LAND MANAGEMENT
MINING CLAIMS
(MASS) Serial Register Page**

RunDate/Time:08/08/16 11:10 AM

Page: 3 of 4

01 05-10-1872;017STAT0091;30USC26,28,34
Case Type 384101: LODE CLAIM
Commodity:
Claim Name: STING 6
Case Disposition: ACTIVE
Required Maintenance Fee: \$155.00

Total Acres
 20.660

Serial Number
AMC400021
Lead File Number
AMC400019

Name & Address			Int Rel
MONTGOMERY NORMAN	PO BOX 941	COOLIDGE, AZ 85128-0018	CLAIMANT

County/State	District
PINAL County, AZ	GILA DO

Mer Twp	Rng	Sec	Subdivision
14	0020S	0110E 027	NE, SE

Act Date	Code	Action Text	Action Remarks	Receipt Number
03/22/2010	403	LOCATION DATE		
04/20/2010	395	RECORDATION NOTICE RECD	1	2121065
08/06/2015	782	MAINTENANCE FEE PAYMENT	2016;\$155	3360069
07/28/2014	782	MAINTENANCE FEE PAYMENT	2015;\$155	3086180
07/31/2013	682	MAINTENANCE FEE/\$140	2014;\$140	2843684
03/07/2012	682	MAINTENANCE FEE/\$140	2013;\$140	2529191
06/06/2011	682	MAINTENANCE FEE/\$140	2012	2357435
08/16/2010	682	MAINTENANCE FEE/\$140	2011	2191266
04/20/2010	484	LOCATION YEAR / MAINTENAN	2010	2121065
10/17/2012	379	REFUND AUTHORIZED	\$140;TIMELY WAIVER	2634597
09/03/2010	669	LAND STATUS CHECKED		
04/20/2010	501	ACCT ADV IN LEAD FILE	AMC400019-AMC400022	

Line Nr	Remarks
---------	---------

RECEIVED
 BLM AZ STATE OFFICE
 2016 AUG - 8 A 11: 15 /
 PHOENIX, ARIZONA

**DEPARTMENT OF THE INTERIOR
BUREAU OF LAND MANAGEMENT
MINING CLAIMS
(MASS) Serial Register Page**

RunDate/Time:08/08/16 11:11 AM

Page: 4 of 4

01 05-10-1872;017STAT0091;30USC26,28,34
Case Type 384101: LODE CLAIM
Commodity:
Claim Name: WATSONVILLE
Case Disposition: ACTIVE
Required Maintenance Fee: \$155.00

Total Acres
 20.660

Serial Number
AMC400022
Lead File Number
AMC400019

<u>Name & Address</u>	<u>Int Rel</u>
MONTGOMERY NORMAN PO BOX 941 COOLIDGE, AZ 85128-0018	CLAIMANT

<u>County/State</u>	<u>District</u>
PINAL County, AZ	PHOENIX DO

<u>Mer Twp</u>	<u>Rng</u>	<u>Sec</u>	<u>Subdivision</u>
14	0020S	0110E	023 NW, SW
14	0020S	0110E	026 NW

<u>Act Date</u>	<u>Code</u>	<u>Action Text</u>	<u>Action Remarks</u>	<u>Receipt Number</u>
03/22/2010	403	LOCATION DATE		
04/20/2010	395	RECORDATION NOTICE RECD	1	2121065
08/06/2015	782	MAINTENANCE FEE PAYMENT	2016;\$155	3360069
07/28/2014	782	MAINTENANCE FEE PAYMENT	2015;\$155	3086180
07/31/2013	682	MAINTENANCE FEE/\$140	2014;\$140	2843684
03/07/2012	682	MAINTENANCE FEE/\$140	2013;\$140	2529191
06/06/2011	682	MAINTENANCE FEE/\$140	2012	2357435
08/16/2010	682	MAINTENANCE FEE/\$140	2011	2191266
04/20/2010	484	LOCATION YEAR / MAINTENAN	2010	2121065
10/17/2012	379	REFUND AUTHORIZED	\$140;TIMELY WAIVER	2634597
09/03/2010	669	LAND STATUS CHECKED		
04/20/2010	501	ACCT ADV IN LEAD FILE	AMC400019-AMC400022	

<u>Line Nr</u>	<u>Remarks</u>
----------------	----------------

RECEIVED
 BLM AZ STATE OFFICE
 2016 AUG - 8 A 11:15
 PHOENIX, ARIZONA

**DEPARTMENT OF THE INTERIOR
BUREAU OF LAND MANAGEMENT
MINING CLAIMS
(MASS) Serial Register Page**

RunDate/Time:08/08/16 11:11 AM

Page: 1 of 8

01 05-10-1872;017STAT0091;30USC26,28,34
Case Type 384101: LODE CLAIM
Commodity:
Claim Name: APTOS
Case Disposition: ACTIVE
Required Maintenance Fee: \$155.00

Total Acres
13.860

Serial Number
AMC414304
Lead File Number
AMC414304

<u>Name & Address</u>	<u>Int Rel</u>
MONTGOMERY NORMAN PO BOX 941 COOLIDGE, AZ 85128-0018	CLAIMANT

<u>County/State</u>	<u>District</u>
PINAL County, AZ	PHOENIX DO

<u>Mer Twp</u>	<u>Rng</u>	<u>Sec</u>	<u>Subdivision</u>
14	0020S	0110E	022 SE
14	0020S	0110E	023 SW

<u>Act Date</u>	<u>Code</u>	<u>Action Text</u>	<u>Action Remarks</u>	<u>Receipt Number</u>
12/14/2011	403	LOCATION DATE		
03/07/2012	395	RECORDATION NOTICE RECD	1	2529159
08/06/2015	782	MAINTENANCE FEE PAYMENT	2016;\$155	3360069
07/28/2014	782	MAINTENANCE FEE PAYMENT	2015;\$155	3086180
07/31/2013	682	MAINTENANCE FEE/\$140	2014;\$140	2843684
03/07/2012	682	MAINTENANCE FEE/\$140	2013;\$140	2529159
03/07/2012	484	LOCATION YEAR / MAINTENAN	2012	2529159
10/17/2012	379	REFUND AUTHORIZED	\$140;TIMELY WAIVER	2634597
06/20/2012	669	LAND STATUS CHECKED		
03/07/2012	501	ACCT ADV IN LEAD FILE	AMC414304-AMC414311;	
02/28/2012	404	COUNTY RECORDATION	2012015773	

<u>Line Nr</u>	<u>Remarks</u>
-----------------------	-----------------------

RECEIVED
BLM AZ STATE OFFICE
2016 AUG - 8 A 11: 15
PHOENIX, ARIZONA

**DEPARTMENT OF THE INTERIOR
BUREAU OF LAND MANAGEMENT
MINING CLAIMS
(MASS) Serial Register Page**

RunDate/Time:08/08/16 11:11 AM

Page: 2 of 8

01 05-10-1872;017STAT0091;30USC26,28,34
Case Type 384101: LODE CLAIM
Commodity:
Claim Name: CAPITOLA
Case Disposition: ACTIVE
Required Maintenance Fee: \$155.00

Total Acres
20.660

Serial Number
AMC414305
Lead File Number
AMC414304

<u>Name & Address</u>	<u>Int Rel</u>
MONTGOMERY NORMAN PO BOX 941 COOLIDGE, AZ 85128-0018	CLAIMANT

<u>County/State</u>	<u>District</u>
PINAL County, AZ	PHOENIX DO

<u>Mer Twp</u>	<u>Rng</u>	<u>Sec</u>	<u>Subdivision</u>
14	0020S	0110E	022 NE
14	0020S	0110E	023 NW

<u>Act Date</u>	<u>Code</u>	<u>Action Text</u>	<u>Action Remarks</u>	<u>Receipt Number</u>
12/14/2011	403	LOCATION DATE		
03/07/2012	395	RECORDATION NOTICE RECD	1	2529159
08/06/2015	782	MAINTENANCE FEE PAYMENT	2016;\$155	3360069
07/28/2014	782	MAINTENANCE FEE PAYMENT	2015;\$155	3086180
07/31/2013	682	MAINTENANCE FEE/\$140	2014;\$140	2843684
03/07/2012	682	MAINTENANCE FEE/\$140	2013;\$140	2529159
03/07/2012	484	LOCATION YEAR / MAINTENAN	2012	2529159
10/17/2012	379	REFUND AUTHORIZED	\$140;TIMELY WAIVER	2634597
06/20/2012	669	LAND STATUS CHECKED		
03/07/2012	501	ACCT ADV IN LEAD FILE	AMC414304-AMC414311;	
02/28/2012	404	COUNTY RECORDATION	2012015772	

<u>Line Nr</u>	<u>Remarks</u>
----------------	----------------

RECEIVED
 BLM AZ STATE OFFICE
 2016 AUG - 8 A 11:15
 PHOENIX, ARIZONA

**DEPARTMENT OF THE INTERIOR
BUREAU OF LAND MANAGEMENT
MINING CLAIMS
(MASS) Serial Register Page**

RunDate/Time:08/08/16 11:11 AM

Page: 3 of 8

01 05-10-1872;017STAT0091;30USC26,28,34
Case Type 384101: LODE CLAIM
Commodity:
Claim Name: MIRAMAR
Case Disposition: ACTIVE
Required Maintenance Fee: \$155.00

Total Acres
 20.660

Serial Number
AMC414306
Lead File Number
AMC414304

<u>Name & Address</u>	<u>Int Rel</u>
MONTGOMERY NORMAN PO BOX 941 COOLIDGE, AZ 85128-0018	CLAIMANT

<u>County/State</u>	<u>District</u>
PINAL County, AZ	PHOENIX DO

<u>Mer Twp</u>	<u>Rng</u>	<u>Sec</u>	<u>Subdivision</u>
14	0020S	0110E	022 NE, SE
14	0020S	0110E	023 NW, SW

<u>Act Date</u>	<u>Code</u>	<u>Action Text</u>	<u>Action Remarks</u>	<u>Receipt Number</u>
12/14/2011	403	LOCATION DATE		
03/07/2012	395	RECORDATION NOTICE RECD	1	2529159
08/06/2015	782	MAINTENANCE FEE PAYMENT	2016;\$155	3360069
07/28/2014	782	MAINTENANCE FEE PAYMENT	2015;\$155	3086180
07/31/2013	682	MAINTENANCE FEE/\$140	2014;\$140	2843684
03/07/2012	682	MAINTENANCE FEE/\$140	2013;\$140	2529159
03/07/2012	484	LOCATION YEAR / MAINTENAN	2012	2529159
10/17/2012	379	REFUND AUTHORIZED	\$140;TIMELY WAIVER	2634597
06/20/2012	669	LAND STATUS CHECKED		
03/07/2012	501	ACCT ADV IN LEAD FILE	AMC414304-AMC414311;	
02/28/2012	404	COUNTY RECORDATION	2012015774	

<u>Line Nr</u>	<u>Remarks</u>
----------------	----------------

RECEIVED
 BLM AZ STATE OFFICE
 2016 AUG -8 A 11:15
 PHOENIX, ARIZONA

DEPARTMENT OF THE INTERIOR
BUREAU OF LAND MANAGEMENT
MINING CLAIMS
(MASS) Serial Register Page

RunDate/Time:08/08/16 11:11 AM

Page: 4 of 8

01 05-10-1872;017STAT0091;30USC26,28,34

Case Type 384101: LODE CLAIM

Commodity:

Claim Name: STING 1

Case Disposition: ACTIVE

Required Maintenance Fee: \$155.00

Total Acres

20.480

Serial Number

AMC414307

Lead File Number

AMC414304

Name & Address

MONTGOMERY NORMAN

PO BOX 941

COOLIDGE, AZ 85128-0018

Int Rel

CLAIMANT

County/State

PINAL County, AZ

District

PHOENIX DO

Mer Twp Rng Sec Subdivision

14 0020S 0110E 015 SE

14 0020S 0110E 022 NE

Act Date	Code	Action Text	Action Remarks	Receipt Number
12/16/2011	403	LOCATION DATE		
03/07/2012	395	RECORDATION NOTICE RECD	1	2529159
08/06/2015	782	MAINTENANCE FEE PAYMENT	2016;\$155	3360069
07/28/2014	782	MAINTENANCE FEE PAYMENT	2015;\$155	3086180
07/31/2013	682	MAINTENANCE FEE/\$140	2014;\$140	2843684
03/07/2012	682	MAINTENANCE FEE/\$140	2013;\$140	2529159
03/07/2012	484	LOCATION YEAR / MAINTENAN	2012	2529159
10/17/2012	379	REFUND AUTHORIZED	\$140;TIMELY WAIVER	2634597
06/20/2012	669	LAND STATUS CHECKED		
03/07/2012	501	ACCT ADV IN LEAD FILE	AMC414304-AMC414311;	
02/28/2012	404	COUNTY RECORDATION	2012015779	

Line Nr Remarks

RECEIVED
BLM AZ STATE OFFICE
2016 AUG - 8 A 11:15
PHOENIX, ARIZONA

**DEPARTMENT OF THE INTERIOR
BUREAU OF LAND MANAGEMENT
MINING CLAIMS
(MASS) Serial Register Page**

RunDate/Time:08/08/16 11:11 AM

Page: 5 of 8

01 05-10-1872;017STAT0091;30USC26,28,34
Case Type 384101: LODGE CLAIM
Commodity:
Claim Name: STING 2
Case Disposition: ACTIVE
Required Maintenance Fee: \$155.00

Total Acres
10.360

Serial Number
AMC414308
Lead File Number
AMC414304

<u>Name & Address</u>	<u>Int Rel</u>
MONTGOMERY NORMAN PO BOX 941 COOLIDGE, AZ 85128-0018	CLAIMANT

<u>County/State</u>	<u>District</u>
PINAL County, AZ	PHOENIX DO

<u>Mer Twp</u>	<u>Rng</u>	<u>Sec</u>	<u>Subdivision</u>
14	0020S	0110E	022 NE

<u>Act Date</u>	<u>Code</u>	<u>Action Text</u>	<u>Action Remarks</u>	<u>Receipt Number</u>
12/14/2011	403	LOCATION DATE		
03/07/2012	395	RECORDATION NOTICE RECD	1	2529159
08/06/2015	782	MAINTENANCE FEE PAYMENT	2016;\$155	3360069
07/28/2014	782	MAINTENANCE FEE PAYMENT	2015;\$155	3086180
07/31/2013	682	MAINTENANCE FEE/\$140	2014;\$140	2843684
03/07/2012	682	MAINTENANCE FEE/\$140	2013;\$140	2529159
03/07/2012	484	LOCATION YEAR / MAINTENAN	2012	2529159
10/17/2012	379	REFUND AUTHORIZED	\$140;TIMELY WAIVER	2634597
06/20/2012	669	LAND STATUS CHECKED		
03/07/2012	501	ACCT ADV IN LEAD FILE	AMC414304-AMC414311;	

<u>Line Nr</u>	<u>Remarks</u>
----------------	----------------

RECEIVED
 BLM AZ STATE OFFICE
 2016 AUG - 8 A 11: 15
 PHOENIX, ARIZONA

**DEPARTMENT OF THE INTERIOR
BUREAU OF LAND MANAGEMENT
MINING CLAIMS
(MASS) Serial Register Page**

RunDate/Time:08/08/16 11:11 AM

Page: 6 of 8

01 05-10-1872;017STAT0091;30USC26,28,34
Case Type 384101: LODE CLAIM
Commodity:
Claim Name: STING 3
Case Disposition: ACTIVE
Required Maintenance Fee: \$155.00

Total Acres
17.890

Serial Number
AMC414309
Lead File Number
AMC414304

<u>Name & Address</u>			<u>Int Rel</u>
MONTGOMERY NORMAN	PO BOX 941	COOLIDGE, AZ 85128-0018	CLAIMANT

<u>County/State</u>	<u>District</u>
PINAL County, AZ	PHOENIX DO

<u>Mer Twp</u>	<u>Rng</u>	<u>Sec</u>	<u>Subdivision</u>
14	0020S	0110E 022	NE, SE

<u>Act Date</u>	<u>Code</u>	<u>Action Text</u>	<u>Action Remarks</u>	<u>Receipt Number</u>
12/14/2011	403	LOCATION DATE		
03/07/2012	395	RECORDATION NOTICE RECD	1	2529159
08/06/2015	782	MAINTENANCE FEE PAYMENT	2016;\$155	3360069
07/28/2014	782	MAINTENANCE FEE PAYMENT	2015;\$155	3086180
07/31/2013	682	MAINTENANCE FEE/\$140	2014;\$140	2843684
03/07/2012	682	MAINTENANCE FEE/\$140	2013;\$140	2529159
03/07/2012	484	LOCATION YEAR / MAINTENAN	2012	2529159
10/17/2012	379	REFUND AUTHORIZED	\$140;TIMELY WAIVER	2634597
06/20/2012	669	LAND STATUS CHECKED		
03/07/2012	501	ACCT ADV IN LEAD FILE	AMC414304-AMC414311;	
02/28/2012	404	COUNTY RECORDATION	2012015777	

<u>Line Nr</u>	<u>Remarks</u>
----------------	----------------

RECEIVED
BLM AZ STATE OFFICE
2016 AUG -8 A 11:15
PHOENIX, ARIZONA

**DEPARTMENT OF THE INTERIOR
BUREAU OF LAND MANAGEMENT
MINING CLAIMS
(MASS) Serial Register Page**

RunDate/Time:08/08/16 11:11 AM

Page: 7 of 8

01 05-10-1872;017STAT0091;30USC26,28,34

Case Type 384101: LODE CLAIM

Commodity:

Claim Name: STING 4

Case Disposition: ACTIVE

Required Maintenance Fee: \$155.00

Total Acres

10.550

Serial Number

AMC414310

Lead File Number

AMC414304

Name & Address

MONTGOMERY NORMAN

PO BOX 941

COOLIDGE, AZ 85128-0018

Int Rel

CLAIMANT

County/State

PINAL County, AZ

District

PHOENIX DO

Mer Twp Rng Sec Subdivision

14 0020S 0110E 022 SE

Act Date	Code	Action Text	Action Remarks	Receipt Number
12/14/2011	403	LOCATION DATE		
03/07/2012	395	RECORDATION NOTICE RECD	1	2529159
08/06/2015	782	MAINTENANCE FEE PAYMENT	2016;\$155	3360069
07/28/2014	782	MAINTENANCE FEE PAYMENT	2015;\$155	3086180
07/31/2013	682	MAINTENANCE FEE/\$140	2014;\$140	2843684
03/07/2012	682	MAINTENANCE FEE/\$140	2013;\$140	2529159
03/07/2012	484	LOCATION YEAR / MAINTENAN	2012	2529159
10/17/2012	379	REFUND AUTHORIZED	\$140;TIMELY WAIVER	2634609
06/20/2012	669	LAND STATUS CHECKED		
03/07/2012	501	ACCT ADV IN LEAD FILE	AMC414304-AMC414311;	
02/28/2012	404	COUNTY RECORDATION	2012015776	

Line Nr Remarks

RECEIVED
BLM AZ STATE OFFICE
2016 AUG -8 A 11:16
PHOENIX, ARIZONA

NO WARRANTY IS MADE BY BLM
FOR USE OF THE DATA FOR
PURPOSES NOT INTENDED BY BLM

**DEPARTMENT OF THE INTERIOR
BUREAU OF LAND MANAGEMENT
MINING CLAIMS
(MASS) Serial Register Page**

RunDate/Time:08/08/16 11:11 AM

Page: 8 of 8

01 05-10-1872;017STAT0091;30USC26,28,34
Case Type 384101: LODE CLAIM
Commodity:
Claim Name: STING 5
Case Disposition: ACTIVE
Required Maintenance Fee: \$155.00

Total Acres
13.860

Serial Number
AMC414311
Lead File Number
AMC414304

<u>Name & Address</u>	<u>Int Rel</u>
MONTGOMERY NORMAN PO BOX 941 COOLIDGE, AZ 85128-0018	CLAIMANT

<u>County/State</u>	<u>District</u>
PINAL County, AZ	PHOENIX DO

<u>Mer Twp</u>	<u>Rng</u>	<u>Sec</u>	<u>Subdivision</u>
14	0020S	0110E	022 SE

<u>Act Date</u>	<u>Code</u>	<u>Action Text</u>	<u>Action Remarks</u>	<u>Receipt Number</u>
12/14/2011	403	LOCATION DATE		
03/07/2012	395	RECORDATION NOTICE RECD	1	2529159
08/06/2015	782	MAINTENANCE FEE PAYMENT	2016;\$155	3360069
07/28/2014	782	MAINTENANCE FEE PAYMENT	2015;\$155	3086180
07/31/2013	682	MAINTENANCE FEE/\$140	2014;\$140	2843684
03/07/2012	682	MAINTENANCE FEE/\$140	2013;\$140	2529159
03/07/2012	484	LOCATION YEAR / MAINTENAN	2012	2529159
10/17/2012	379	REFUND AUTHORIZED	\$140;TIMELY WAIVER	2634609
06/20/2012	669	LAND STATUS CHECKED		
03/07/2012	501	ACCT ADV IN LEAD FILE	AMC414304-AMC414311;	
02/28/2012	404	COUNTY RECORDATION	2012015775	

<u>Line Nr</u>	<u>Remarks</u>

RECEIVED
 BLM AZ STATE OFFICE
 2016 AUG - 8 A 11: 16
 PHOENIX, ARIZONA

United States Department of the Interior
Bureau of Land Management
DIV OF LANDS, MINRLS & ENERGY
ONE N CENTRAL AVE
PHOENIX, AZ 85004 -4427
Phone: 602-417-9200

Receipt

No: 3623334

Transaction #: 3727065	
Date of Transaction: 08/08/2016	
CUSTOMER:	
	NORMAN MONTGOMERY PO BOX 941 COOLIDGE, AZ 85128-0018 US

LINE #	QTY	DESCRIPTION	REMARKS	UNIT PRICE	TOTAL
1	1.00	LOCATABLE MINERALS / MINING CLAIMS- NOT NEW-UNADJUD, ONE AUTH NO. ONLY / MINING CLAIM MONEY RECEIVED CASES: AMC83517/\$7905.00	MAINT 2017/20	- n/a -	7905.00
TOTAL:					\$7,905.00

PAYMENT INFORMATION				
1	AMOUNT:	7905.00	POSTMARKED:	N/A
	TYPE:	CHECK	RECEIVED:	08/08/2016
	CHECK NO:	3650		
	NAME:	GILA ROCK PRODUCTS LLC MONTGOMERY, NORMAN PO BOX 941 COOLIDGE AZ 85128-0018 US		

REMARKS

This receipt was generated by the automated BLM Collections and Billing System and is a paper representation of a portion of the official electronic record contained therein.

UNITED STATES
DEPARTMENT OF THE INTERIOR
BUREAU OF LAND MANAGEMENT
**MAINTENANCE FEE PAYMENT FORM
FOR PLACER MINING CLAIMS**

83517
62617
400019
414304

RECEIVED
BLM AZ STATE OFFICE
2015 AUG - 6 A 9:25
PHOENIX, ARIZONA

Remitter Name: VERMONT MONTGOMERY

Mailing Address: PO Box 941

City, State, Zip: Coolidge Az. 85128

☐ Check here if this is a change of address.

FOR COUNTY RECORDER'S USE

No. of claims _____
Total due BLM \$ _____

- The maintenance fee may be paid by cash, check, money order, Bureau of Land Management (BLM) Declining Deposit Account, or credit card (VISA, American Express, Discover, or MasterCard). Payments must be remitted to the BLM State Office where your claim or site is recorded and received on or before September 1. If the payment is mailed, the envelope must be postmarked by a bona fide delivery service on or before September 1 and received at the proper BLM State Office within 15 calendar days after the due date. Payments may also be made by telephone using a credit card. A complete listing of BLM State Offices with their addresses and phone numbers can be found at <http://www.blm.gov>.
- The maintenance fee for the following claim(s) applies to the assessment year _____.

CLAIM NAME	BLM SERIAL NO.	ACRES IN CLAIM	PAYMENT DUE TO THE BLM (See Instructions on Page 2)
BONANZA	83517		1240 ✓
ESPERANZA	83518		1240 ✓
HORSE SHOE	83519		310 ✓
ARIZONA	83520		155 ✓
NOGET	83521		310 ✓
BELL	83522		310 ✓
SHAR SHOT	83523		1240 ✓
HARD NOT	62417		1240 ✓

Use a separate sheet for additional claim names, serial numbers, and claimant names and addresses.

3360069

(Continued on page 2)

BY: Ram

(June 2012)

UNITED STATES
DEPARTMENT OF THE INTERIOR
BUREAU OF LAND MANAGEMENT
**MAINTENANCE FEE PAYMENT FORM
FOR PLACER MINING CLAIMS**

Remitter Name: Norman Montgomery

Mailing Address: PO Box 941

City, State, Zip: Coolidge, AZ. 85128

☐ Check here if this is a change of address.

RECEIVED
BLM AZ STATE OFFICE
2015 AUG - 6 A 9:25
PHOENIX, ARIZONA

FOR COUNTY RECORDER'S USE

No. of claims _____

Total due BLM \$ _____

1. The maintenance fee may be paid by cash, check, money order, Bureau of Land Management (BLM) Declining Deposit Account, or credit card (VISA, American Express, Discover, or MasterCard). Payments must be remitted to the BLM State Office where your claim or site is recorded and received on or before September 1. If the payment is mailed, the envelope must be postmarked by a bona fide delivery service on or before September 1 and received at the proper BLM State Office within 15 calendar days after the due date. Payments may also be made by telephone using a credit card. A complete listing of BLM State Offices with their addresses and phone numbers can be found at <http://www.blm.gov>.
2. The maintenance fee for the following claim(s) applies to the assessment year _____.

CLAIM NAME	BLM SERIAL NO.	ACRES IN CLAIM	PAYMENT DUE TO THE BLM (See Instructions on Page 2)
Pajaro	400019		155
Reymont	406020		155
Sting #6	400021		155
Watsonville	400022		155
Aptos	414304		155
Capitola	414305		155
Minamara	414306		155
Sting #1	414307		155
Sting #2	414308		155
Sting #3	414309		155

RECEIVED
BLM AZ STATE OFFICE
2015 AUG - 6 A 9:25

Use a separate sheet for additional claim names, serial numbers, and claimant names and addresses.

(Continued on page 2)

AUG 27 2015
BY: Ram

UNITED STATES
DEPARTMENT OF THE INTERIOR
BUREAU OF LAND MANAGEMENT
**MAINTENANCE FEE PAYMENT FORM
FOR PLACER MINING CLAIMS**

Remitter Name: _____

Mailing Address: _____

City, State, Zip: _____

☐ Check here if this is a change of address.

RECEIVED
BLM AZ STATE OFFICE
2015 AUG - 6 A 9: 30
PHOENIX, ARIZONA

FOR COUNTY RECORDER'S USE

No. of claims _____

Total due BLM \$ _____

1. The maintenance fee may be paid by cash, check, money order, Bureau of Land Management (BLM) Declining Deposit Account, or credit card (VISA, American Express, Discover, or MasterCard). Payments must be remitted to the BLM State Office where your claim or site is recorded and received on or before September 1. If the payment is mailed, the envelope must be postmarked by a bona fide delivery service on or before September 1 and received at the proper BLM State Office within 15 calendar days after the due date. Payments may also be made by telephone using a credit card. A complete listing of BLM State Offices with their addresses and phone numbers can be found at <http://www.blm.gov>.

2. The maintenance fee for the following claim(s) applies to the assessment year _____.

CLAIM NAME	BLM SERIAL NO.	ACRES IN CLAIM	PAYMENT DUE TO THE BLM (See Instructions on Page 2)
Sting # 4	414 310		155
Sting # 5	414 311		155

RECEIVED
BLM AZ STATE OFFICE
2015 AUG - 6 A 9: 25
PHOENIX, ARIZONA

Use a separate sheet for additional claim names, serial numbers, and claimant names and addresses.

(Continued on page 2)

ENTERED
[AUG 07 2015]
BY: Ram

United States Department of the Interior
Bureau of Land Management
LANDS/RECREATION & PLANNING
ONE N CENTRAL AVE
PHOENIX, AZ 85004 -2203
Phone: 602-417-9200

Receipt

No: 3360069

Transaction #: 3458053	
Date of Transaction: 08/06/2015	
CUSTOMER:	
	NORMAN MONTGOMERY PO BOX 941 COOLIDGE, AZ 85128-0018 US

LINE #	QTY	DESCRIPTION	REMARKS	UNIT PRICE	TOTAL
1	1.00	LOCATABLE MINERALS / MINING CLAIMS- NOT NEW-UNADJUD, ONE AUTH NO. ONLY / MINING CLAIM MONEY RECEIVED CASES: AMC83517/\$7905.00	MAINT 2016/20	- n/a -	7905.00
TOTAL:					\$7,905.00

PAYMENT INFORMATION				
1	AMOUNT:	7905.00	POSTMARKED:	N/A
	TYPE:	CHECK	RECEIVED:	08/06/2015
	CHECK NO:	3390		
	NAME:	GILA ROCK PRODUCTS LLC PO BOX 941 COOLIDGE AZ 85128-0018 US		

REMARKS

This receipt was generated by the automated BLM Collections and Billing System and is a paper representation of a portion of the official electronic record contained therein.

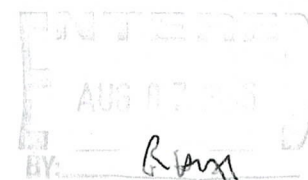

UNITED STATES
DEPARTMENT OF THE INTERIOR
BUREAU OF LAND MANAGEMENT
**MAINTENANCE FEE PAYMENT FORM
FOR PLACER MINING CLAIMS**

AMC 62617
83517
414304
400019

Remitter Name: Norman Montgomery

Mailing Address: PO Box 941

City, State, Zip: Coolidge Az. 85128

☐ Check here if this is a change of address.

FOR COUNTY RECORDER'S USE

No. of claims 8
Total due BLM \$ 5460.00
ERG + 585

- The maintenance fee may be paid by cash, check, money order, Bureau of Land Management (BLM) Declining Deposit Account, or credit card (VISA, American Express, Discover, or MasterCard). Payments must be remitted to the BLM State Office where your claim or site is recorded and received on or before September 1. If the payment is mailed, the envelope must be postmarked by a bona fide delivery service on or before September 1 and received at the proper BLM State Office within 15 calendar days after the due date. Payments may also be made by telephone using a credit card. A complete listing of BLM State Offices with their addresses and phone numbers can be found at <http://www.blm.gov>.
- The maintenance fee for the following claim(s) applies to the assessment year _____.

CLAIM NAME	BLM SERIAL NO.	ACRES IN CLAIM	PAYMENT DUE TO THE BLM (See Instructions on Page 2)
BONANZA	83517	160	1240
ESPERANZA	83518	160	1240
HORSE SHOE	83519	20.66	310
LAIZONA	83520	20	155
NUGET	83521	20.66	310
BALL	83522	20.66	310
SHUN SHOT	83523	160	1240
HARD NUT	62617	160	1240

Use a separate sheet for additional claim names, serial numbers, and claimant names and addresses.

(Continued on page 2)

RECEIVED
BLM AZ STATE OFFICE

ENTERED
JUL 29 2014
BY: RAM

UNITED STATES
DEPARTMENT OF THE INTERIOR
BUREAU OF LAND MANAGEMENT
**MAINTENANCE FEE PAYMENT FORM FOR
LODE CLAIMS, MILL SITES, AND TUNNEL SITES**

Remitter Name: _____

Mailing Address: _____

City, State, Zip: _____

☐ Check here if this is a change of address.

FOR COUNTY RECORDER'S USE

No. of claims/sites 12

x \$140 per claim/site

Total due BLM \$ 1680

EEG + 180

1. The maintenance fee may be paid by cash, check, money order, Bureau of Land Management (BLM) Declining Deposit Account, or credit card (VISA, American Express, Discover, or MasterCard). Payments must be remitted to the BLM State Office where your claim or site is recorded and received on or before September 1. If the payment is mailed, the envelope must be postmarked by a bona fide delivery service on or before September 1 and received at the proper BLM State Office within 15 calendar days after the due date. Payments may also be made by telephone using a credit card. A complete listing of BLM State Offices with their addresses and phone numbers can be found at <http://www.blm.gov>.

2. The maintenance fee for the following claim(s)/site(s) applies to the assessment year _____.

CLAIM/SITE NAME	BLM SERIAL NO.
Pajaro	400019
Axment	400020
Sting #6	400021
Watsonville	400022
APtoS	414304
Capitola	414305
Mirama	414306
Sting #1	414307
Sting #2	414308
Sting #3	414309

2014 JUL 28 A 9:36

Use a separate sheet for additional claim/site names, serial numbers, and claimant names and addresses.

RECEIVED
BLM AZ STATE OFFICE

(Continued on page 2)

ENTERED
JUL 29 2014
BY: PHM

UNITED STATES
DEPARTMENT OF THE INTERIOR
BUREAU OF LAND MANAGEMENT
**MAINTENANCE FEE PAYMENT FORM FOR
LODE CLAIMS, MILL SITES, AND TUNNEL SITES**

Remitter Name: _____

Mailing Address: _____

City, State, Zip: _____

☐ Check here if this is a change of address.

FOR COUNTY RECORDER'S USE

No. of claims/sites _____

x \$140 per claim/site

Total due BLM \$ _____

1. The maintenance fee may be paid by cash, check, money order, Bureau of Land Management (BLM) Declining Deposit Account, or credit card (VISA, American Express, Discover, or MasterCard). Payments must be remitted to the BLM State Office where your claim or site is recorded and received on or before September 1. If the payment is mailed, the envelope must be postmarked by a bona fide delivery service on or before September 1 and received at the proper BLM State Office within 15 calendar days after the due date. Payments may also be made by telephone using a credit card. A complete listing of BLM State Offices with their addresses and phone numbers can be found at <http://www.blm.gov>.
2. The maintenance fee for the following claim(s)/site(s) applies to the assessment year _____.

CLAIM/SITE NAME	BLM SERIAL NO.
Sting # 4	414310
Sting # 5	414311

RECEIVED
BLM AZ STATE OFFICE
2014 JUL 28 A 9:38
PHOENIX, ARIZONA

Use a separate sheet for additional claim/site names, serial numbers, and claimant names and addresses.

(Continued on page 2)

ENTERED
JUL 29 2014
BY: *Ram*

United States Department of the Interior
 Bureau of Land Management
 LANDS/RECREATION & PLANNING
 ONE N CENTRAL AVE
 PHOENIX, AZ 85004 -2203
 Phone: 602-417-9200

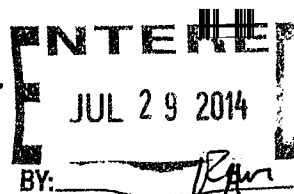

Receipt

No:

3086180

Transaction #: 3177510	
Date of Transaction: 07/28/2014	
CUSTOMER:	
NORMAN MONTGOMERY PO BOX 941 COOLIDGE, AZ 85128-0018 US	

LINE #	QTY	DESCRIPTION	REMARKS	UNIT PRICE	TOTAL
1	1.00	LOCATABLE MINERALS / MINING CLAIMS- NOT NEW-UNADJUD, ONE AUTH NO. ONLY / MINING CLAIM MONEY RECEIVED CASES: AMC83517/\$7905.00	MAINT (12 LODE 8 PLACER)	- n/a -	7905.00
TOTAL:					\$7,905.00

PAYMENT INFORMATION			
NOTE: Items will appear on credit card statement as "Bureau of Land Mgmt CO".			
1	AMOUNT:	765.00	POSTMARKED: N/A
	TYPE:	CREDIT CARD	RECEIVED: 07/28/2014
	NAME:	MONTGOMERY, NORMAN PO BOX 941 COOLIDGE AZ 85128-0018 US	
	CARD NO:	XXXXXXXXXXXX4135	AUTH CODE: 050952
	NAME ON CARD:	NORMAN M MONTGOMERY	
	EXPIRES:	06/2016	
	SIGNATURE:		
2	AMOUNT:	7140.00	POSTMARKED: N/A
	TYPE:	CHECK	RECEIVED: 07/28/2014
	CHECK NO:	3135	
	NAME:	MONTGOMERY, NORMAN PO BOX 941 COOLIDGE AZ 85128-0018 US	

AMC 400019

AMC 414304

AMC 83517

AMC 62617

MAINTENANCE FEE PAYMENT

Claimant Name: NORMAN MONTGOMERY

Address: PO Box 941

City: Coolidge State: AZ Zip: 85128

Telephone: 520 709 0172

E-mail address: NORMANEX@Gmail.com

Signature: Norman Montgomery

☐ Check here if this is a change of address.

BLM Date Stamp	RECEIVED BLM AZ STATE OFFICE PHOENIX, ARIZONA 2013 JUL 31 A 11:29
----------------------	--

LINE NO.	AMC NUMBER	CLAIM/SITE NAME	COUNTY RECORDER DATA (If available)	TWP	RNG	SEC
1	400019	Pd J no				
2	400020	Payment				
3	400021	STING # 6				
4	400022	WATSONVILLE				
5	414304	A P T O S				
6	414305	Capitol				
7	414306	MIRAMAR				
8	414307	STING # 1				
9	414308	STING # 2				
10	414309	STING # 3				

List additional claims on Form MCF114.

Bureau of Land Management
Arizona State Office
www.blm.gov/az/

No. of Claims: 12 x \$140 = 1680
Check No: 26517 Init. EG
Receipt No.: 2843684
For BLM Use Only

Form: MCF112
Revised July 2009

This form is available from the Arizona Department of Mines and Mineral Resources and may be reproduced.

ENTERED INTO COMPUTER

AUG 08 2013

18

May be used with the following forms for listing additional mining claims:

☐ Affidavit of Performance of Annual Work
☒ Maintenance Fee Payment
☐ Notice of Intent to Hold Mining Claims
☐ Notice of Non-Liability for Labor and Materials Furnished

RECEIVED
ELM AZ STATE OF
2013 JUL 31 A 11
PHOENIX, ARIZO
BLM
Date Stamp

[illegible]

Form MCF114
Revised June 2005

This form is available from the **Arizona Department of Mines & Mineral Resources** and may be reproduced.

MAINTENANCE FEE PAYMENT

Claimant Name: Norman Montgomery
 Address: PO Box 941
 City: Coolidge State: AZ Zip: 85128
 Telephone: 520 769 0172
 E-mail address: normanmontgomery@gmail.com
 Signature: Norman Montgomery
☐ Check here if this is a change of address.

RECEIVED BLM #2 STATE OFFICE 2013 JUL 31 A 11:29 PHOENIX, ARIZONA	BLM Date Stamp
--	----------------------

PLACER

LINE NO.	AMC NUMBER	CLAIM/SITE NAME	COUNTY RECORDER DATA (If available)	TWP	RNG	SEC
1	83517	BONANZA				
2	83518	ESPERANZA				
3	83519	HORSE SHOE				
4	83520	ARIZONA				
5	83521	NUGET				
6	83522	BELL				
7	83523	SUR SHOT				
8	62617	HAND NOT				
9						
10						

List additional claims on Form MCF114.

Bureau of Land Management
 Arizona State Office
www.blm.gov/az/

No. of Claims: 8 x \$140 = 5460
 Check No: 26517 Init. ES
 Receipt No.: 2843684
 For BLM Use Only

Form: MCF112
 Revised July 2009

This form is available from the Arizona Department of Mines and Mineral Resources and may be reproduced.

United States Department of the Interior
Bureau of Land Management
 LANDS/RECREATION & PLANNING
 ONE N CENTRAL AVE
 PHOENIX, AZ 85004 -2203
 Phone: 602-417-9200

Receipt

No: 2843684

Transaction #: 2929312	
Date of Transaction: 07/31/2013	
CUSTOMER:	
	NORMAN MONTGOMERY PO BOX 941 COOLIDGE, AZ 85128-0018 US

LINE #	QTY	DESCRIPTION	REMARKS	UNIT PRICE	TOTAL
1	1.00	LOCATABLE MINERALS / MINING CLAIMS- NOT NEW-UNADJUD, ONE AUTH NO. ONLY / MINING CLAIM MONEY RECEIVED CASES: AMC400019/\$7140.00	2014 MAINT (12+8)	- n/a -	7140.00
TOTAL:					\$7,140.00

PAYMENT INFORMATION			
1	AMOUNT:	7140.00	POSTMARKED: N/A
	TYPE:	CHECK	RECEIVED: 07/31/2013
	CHECK NO:	26517	
	NAME:	MONTGOMERY, NORMAN PO BOX 941 COOLIDGE AZ 85128-0018 US	

REMARKS

This receipt was generated by the automated BLM Collections and Billing System and is a paper representation of a portion of the official electronic record contained therein.

400019

414304

Authorized Date 10/17/2012

Instructions to Accounts AZ BLM REFUND \$1400 TO NORMAN MONTGOMERY FOR
MAINTENANCE FEES PAID ON AMC400019-022 AND
AMC414304-309 BUT REPLACED BY TIMELY WAIVER.
RECEIPT#2634597. RE.

Login ID 4105

Entry Date 10/17/2012

Total Amount \$1,400.00

400019
414304

Authorized Date 10/17/2012

Instructions to Accounts AZ BLM REFUND \$280 TO NORMAN MONTGOMERY FOR
MAINTENANCE FEES PAID ON AMC414310 AND AMC414311
BUT REPLACED BY A TIMELY WAIVER. RECEIPT #2634609.
RE.

Login ID 4105

Entry Date 10/17/2012

Total Amount \$280.00

Amc 400019
Amc 414304

MAINTENANCE FEE PAYMENT

Claimant Name: NORMAN MONTGOMERY
Address: PO Box 941
City: COOLIDGE State: AZ Zip: 85128
Telephone: 520 709 0172
E-mail address: NORMANMEX@GMAIL.COM
Signature: Norman Montgomery
☐ Check here if this is a change of address.

RECEIVED BLM AZ STATE OFFICE 2012 AUG 20 A 10:57 PHOENIX, ARIZONA BLM Date Stamp
--

LINE NO.	AMC NUMBER	CLAIM/SITE NAME	COUNTY RECORDER DATA (If available)	TWP	RNG	SEC
1	400019	Pejaro				
2	400020	Reymont				
3	400021	Sting 6				
4	400022	Watsonville				
5	414304	HP405				
6	414305	Capitola				
7	414306	Miamia				
8	414307	Sting 1				
9	414308	Sting 2				
10	414309	Sting 3				

List additional claims on Form MCF114.

Bureau of Land Management
Arizona State Office
WWW.BLM.GOV/AZ/

No. of Claims: 10 x \$140 = \$1400.00
Check No: 2652 Init. ERG
Receipt No.: 2634597
For BLM Use Only

\$1400 refund authorized RE
see receipt for details 10/17/12
Form: MCF112
Revised July 2009

This form is available from the Arizona Department of Mines and Mineral Resources and may be reproduced.

pd for Amc 400019-400020 # 2529191 \$500 3/7/12 Refund 8/20/12 pmt } 1400 + 280
pd for Amc 414304-414311 # 2529159 \$1120 3/7/12 Refund 8/20/12 pmt }

United States Department of the Interior
Bureau of Land Management
LANDS/RECREATION & PLANNING
ONE N CENTRAL AVE
PHOENIX, AZ 85004 -2203
Phone: 602-417-9200

Receipt

No: 2634597

Transaction #: 2715162
Date of Transaction: 08/20/2012

CUSTOMER:

NORMAN MONTGOMERY
PO BOX 941
COOLIDGE, AZ 85128-0018 US

LINE #	QTY	DESCRIPTION	REMARKS	UNIT PRICE	TOTAL
1	1.00	LOCATABLE MINERALS / MINING CLAIMS- NOT NEW-UNADJUD, ONE AUTH NO. ONLY / MINING CLAIM MONEY RECEIVED CASES: AMC400019/\$1400.00	2013 MAINT (10)	- n/a -	1400.00
TOTAL:					\$1,400.00

PAYMENT INFORMATION			
1	AMOUNT:	1400.00	POSTMARKED: N/A
	TYPE:	CHECK	RECEIVED: 08/20/2012
	CHECK NO:	2652	
	NAME:	MONTGOMERY, NORMAN PO BOX 941 COOLIDGE AZ 85128-0018 US	

REMARKS

This receipt was generated by the automated BLM Collections and Billing System and is a paper representation of a portion of the official electronic record contained therein.

\$1400 refund authorized for
maint fee pd on AMC 400019-022 on
AMC 414304 214311 but replaced by a
timely waiver.

RS 10-17-17

MAINTENANCE FEE PAYMENT

Claimant Name: Norman Montgomery
 Address: PO Box 941
 City: Casa Grande State: AZ Zip: 85128
 Telephone: 520 709 0172
 E-mail address: normanmontgomery@gmail.com
 Signature: Norman Montgomery
☐ Check here if this is a change of address.

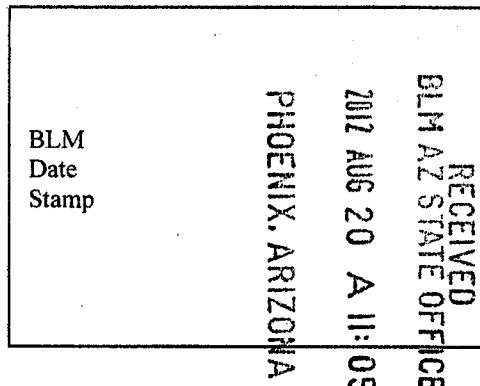

LINE NO.	AMC NUMBER	CLAIM/SITE NAME	COUNTY RECORDER DATA (If available)	TWP	RNG	SEC
1	414310	String 4				
2	414311	String 5				
3						
4						
5						
6						
7						
8						
9						
10						

List additional claims on Form MCF114.

Bureau of Land Management
 Arizona State Office
www.blm.gov/az/

No. of Claims: 2 x \$140 = 280.00
 Check No: 2652 Init. BC
 Receipt No.: 2634609
 For BLM Use Only

Form: MCF112
 Revised July 2009

This form is available from the Arizona Department of Mines and Mineral Resources and may be reproduced.

\$280 refund authorized
 (see receipt for details)

United States Department of the Interior
Bureau of Land Management
LANDS/RECREATION & PLANNING
ONE N CENTRAL AVE
PHOENIX, AZ 85004 -2203
Phone: 602-417-9200

Receipt

No:

2634609

Transaction #: 2715176	
Date of Transaction: 08/20/2012	
CUSTOMER:	
	NORMAN MONTGOMERY PO BOX 941 COOLIDGE, AZ 85128-0018 US

LINE #	QTY	DESCRIPTION	REMARKS	UNIT PRICE	TOTAL
1	1.00	LOCATABLE MINERALS / MINING CLAIMS- NOT NEW-UNADJUD, ONE AUTH NO. ONLY / MINING CLAIM MONEY RECEIVED CASES: AMC414310/\$280.00	2013 MAINT (2)	- n/a -	280.00
TOTAL:					\$280.00

PAYMENT INFORMATION				
1	AMOUNT:	280.00	POSTMARKED:	N/A
	TYPE:	CHECK	RECEIVED:	08/20/2012
	CHECK NO:	2652		
	NAME:	MONTGOMERY, NORMAN PO BOX 941 COOLIDGE AZ 85128-0018 US		

REMARKS

This receipt was generated by the automated BLM Collections and Billing System and is a paper representation of a portion of the official electronic record contained therein.

\$280 refund authorized for
maint fees paid on AMC4143
& AMC 414311 but replaced by
timely waiver
RE 10-17-12

United States Department of the Interior
Bureau of Land Management
 LANDS/RECREATION & PLANNING
 ONE N CENTRAL AVE
 PHOENIX, AZ 85004 -2203
 Phone: 602-417-9200

Receipt

No: 2529159

Transaction #: 2607422	
Date of Transaction: 03/07/2012	
CUSTOMER:	
	NORMAN MONTGOMERY PO BOX 941 COOLIDGE, AZ 85128-0018 US

LINE #	QTY	DESCRIPTION	REMARKS	UNIT PRICE	TOTAL
1	8.00	LOCATABLE MINERALS / MINING CLAIMS-NEW, UNADJUD, ONE OR MORE AUTH NOS / NEW MINING CLAIM LOCATION FEE \$34 CASES: AMC414304/\$34.00, AMC414305/\$34.00, AMC414306/\$34.00, AMC414307/\$34.00, AMC414308/\$34.00, AMC414309/\$34.00, AMC414310/\$34.00, AMC414311/\$34.00		- n/a -	272.00
2	8.00	LOCATABLE MINERALS / MINING CLAIMS-NEW, UNADJUD, ONE OR MORE AUTH NOS / NEW MINING CLAIM MAINT FEE \$140 CASES: AMC414304/\$140.00, AMC414305/\$140.00, AMC414306/\$140.00, AMC414307/\$140.00, AMC414308/\$140.00, AMC414309/\$140.00, AMC414310/\$140.00, AMC414311/\$140.00		- n/a -	1120.00
3	8.00	LOCATABLE MINERALS / MINING CLAIMS-NEW, UNADJUD, ONE OR MORE AUTH NOS / NEW MINING CLAIM PROCESSING FEE \$15 CASES: AMC414304/\$15.00, AMC414305/\$15.00, AMC414306/\$15.00, AMC414307/\$15.00, AMC414308/\$15.00, AMC414309/\$15.00, AMC414310/\$15.00, AMC414311/\$15.00		- n/a -	120.00
4	8.00	LOCATABLE MINERALS / MINING CLAIMS-NEW, UNADJUD, ONE OR MORE AUTH NOS / NEW MINING CLAIM MAINT FEE \$140 CASES: AMC414304/\$140.00, AMC414305/\$140.00, AMC414306/\$140.00, AMC414307/\$140.00, AMC414308/\$140.00, AMC414309/\$140.00, AMC414310/\$140.00, AMC414311/\$140.00	MAINT 2013/8	- n/a -	1120.00
TOTAL:					\$2,632.00

PAYMENT INFORMATION				
1	AMOUNT:	2632.00	POSTMARKED:	N/A
	TYPE:	CHECK	RECEIVED:	03/07/2012
	CHECK NO:	26508		
	NAME:	MONTGOMERY, NORMAN PO BOX 941 COOLIDGE AZ 85128-0018 US		

REMARKS

This receipt was generated by the automated BLM Collections and Billing System and is a paper representation of a portion of the official electronic record contained therein.

United States Department of the Interior
Bureau of Land Management
LANDS/RECREATION & PLANNING
ONE N CENTRAL AVE
PHOENIX, AZ 85004 -2203
Phone: 602-417-9200

Receipt

No: 2529191

Transaction #: 2607457	
Date of Transaction: 03/07/2012	
CUSTOMER:	
	NORMAN MONTGOMERY PO BOX 941 COOLIDGE, AZ 85128-0018 US

LINE #	QTY	DESCRIPTION	REMARKS	UNIT PRICE	TOTAL
1	1.00	LOCATABLE MINERALS / MINING CLAIMS- NOT NEW-UNADJUD, ONE AUTH NO. ONLY / MINING CLAIM MONEY RECEIVED CASES: AMC400019/\$560.00	MAINT 2013/4	- n/a -	560.00
TOTAL:					\$560.00

PAYMENT INFORMATION				
1	AMOUNT:	560.00	POSTMARKED:	N/A
	TYPE:	CHECK	RECEIVED:	03/07/2012
	CHECK NO:	26510		
	NAME:	MONTGOMERY, NORMAN PO BOX 941 COOLIDGE AZ 85128-0018 US		

REMARKS

This receipt was generated by the automated BLM Collections and Billing System and is a paper representation of a portion of the official electronic record contained therein.

NOTICE!!

These documents have been scanned!

Do not place un-scanned documents beneath this notice!

Do not remove this notice from this file!

GPO Jacket No. 560-102
Print Order 61540
Rise Business Services, LLC
Job=AZ15 5/14/2019



Box Number= AZ15050



Claim Begin-End: AMC414304-AMC414311

6 Location Notices-Amendments and Supporting Documents



AZ15050-10

AMC414065-AMC414430

MINING CLAIM STATUS REPORT

DATA

ENTERED MAR 16 2012 *pb*

MTP Checked by MAR 16 2012 *pb*

GEO Checked by MAR 16 2012 *pb*

LEAD SERIAL NUMBER AMC 414304 thru AMC 414311

OF CLAIMS & TYPE

8 LODE
_____ PLACER
_____ ASSOCIATION PLACER
_____ MILL SITE
_____ TUNNEL SITE

CHARGES

Location Fee @ \$34 = \$ 272
Processing Fee @ \$15 = \$ 120
Maintenance Fee @ \$140 = \$ 1120
Overage (+) \$ _____
Shortage (-) \$ _____
Other Fees \$ _____

TOTAL \$ 1512.00

ARE THERE ENOUGH LOCATORS?

Yes () No () _____

DOCUMENTS RECEIVED VIA -

Over-the-Counter (X) Mail ()

TIMELY FILED?

Yes (X) No ()

accepted as mail

LEGAL DESCRIPTION - T 25 R 11E SEC 15, 22, 23
T _____ R _____ SEC _____
T _____ R _____ SEC _____
T _____ R _____ SEC _____

ANCH 414304

BLM () FOREST SERVICE (X) 10N50 SUBJ TO PL 359: Yes () No ()

WILDERNESS AREA: No () Yes () _____

SPLIT ESTATE - N/A () SX () PX () SRHA () OTHER () _____

Proper Notice Filed if Located on SHRA Lands? N/A () Yes () No ()

RECONVEYED MINERALS ON BLM LANDS REQUIRE OPENING ORDERS FROM 1944 TO 1993 -

Open to Entry on: _____ N/A ()

COMMENTS/STATUS - VOID () PARTIALLY VOID () PVT MINERALS () WITHDRAWN LANDS ()

OTHER () _____

Claimant acknowledges that portions of the following claims(s) site(s) may be void or voidable.

Printed Name of Claimant _____ Signature of Claimant _____

***** FINAL ADJUDICATION *****

DATE 6-20-12 INITIALS RE

Return to address
listed below



OFFICIAL RECORDS OF
PINAL COUNTY RECORDER
LAURA DEAN-LYTLE

The following Document contains no Personal Information
as defined by NRS 603A.040

**CERTIFICATE OF LOCATION
LODE MINING CLAIM**

DATE/TIME: 02/28/2012 1321
FEE: \$9.00
PAGES: 2
FEE NUMBER: 2012-015773



TO ALL WHOM IT MAY CONCERN:

The locator hereby certifies that he has caused to be located the
Aptos Lode Mining Claim in the
following quarter sections(s):

1/4	Section	Township	Range	Meridian
	<u>22 & 23</u>	<u>2 South</u>	<u>11 East</u>	<u>MDB&M</u>
				<u>MDB&M</u>
				<u>MDB&M</u>
				<u>MDB&M</u>

Adjoining the Africa Patented
Claim MS2878 A to the
Northeast

RECORDER'S STAMP

in Pinal County, Az. on the 14 day of December, 2011. ← use as Loc. date per RE

Name and mailing address of locator is:

Norman Montgomery
P.O. Box 941
Coolidge, Az 85128

The Claim is approximately 1000 feet long and 1000 feet wide, such that 0 feet
are claimed in a Northwest direction and 1000 feet in a Southwest direction from the point of
discovery (monument of location), at which the Notice of Location was posted, together with 300
feet on each side of the monument of location and center line of the Claim. The general course of the
lode or vein is from the Northwest to the Southeast direction.

The number, location and markings on each corner monument are as follows:

No.	Location	Markings	Description
No. 1:	<u>North east Corner</u>	<u>1000 Ft</u>	<u>North 65° 20' East</u>
No. 2:	<u>South east Corner</u>	<u>1000 Ft</u>	<u>South 17° 45' East</u>
No. 3:	<u>South west Corner</u>	<u>1000 Ft</u>	<u>South 65° 20' West</u>
No. 4:	<u>North west Beginning</u>	<u>1000 Ft</u>	<u>North 17° 45' West</u>

As erected on the ground, each corner monument is marked as described above by
(e.g. metal tags, paint on posts).

The work of location consisted of making a claim map as provided in NRS 517.040.

Dated this 11 day of Dec, 2011.

NAME OF LOCATOR:

By Norman Montgomery
Owner, Claimant, or Agent Signature

Norman Montgomery
Owner, Claimant, or Agent Name (printed)

Suggested Form - Nevada Division of Minerals (REV. 4/15/2009-LV)
Nevada Lode Certificate of Location - NRS 517.050

RECEIVED
B.L.M. AZ STATE OFFICE
2012 MAR -7 A 11:59
PHOENIX, AZ

ANC 414304

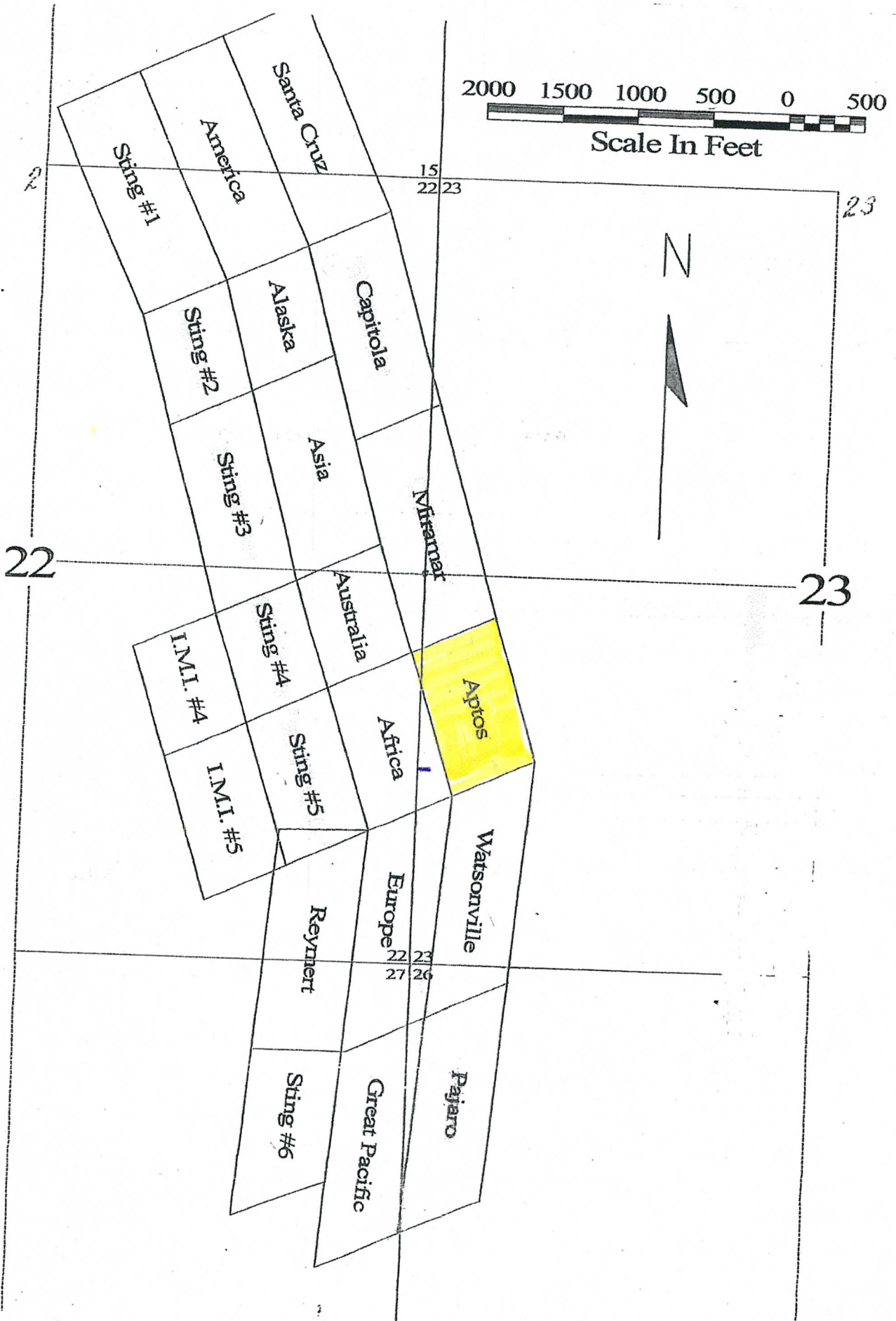

Return to address
listed below



OFFICIAL RECORDS OF
PINAL COUNTY RECORDER
LAURA DEAN-LYTLE

DATE/TIME: 02/28/2012 1321
FEE: \$9.00
PAGES: 2
FEE NUMBER: 2012-015772



The following Document contains no Personal Information
as defined by NRS 603A.040

**CERTIFICATE OF LOCATION
LODE MINING CLAIM**

TO ALL WHOM IT MAY CONCERN:

The locator hereby certifies that he has caused to be located the
Capitola Lode Mining Claim in the
following quarter sections(s):

1/4	Section	Township	Range	Meridian
	<u>22 & 23</u>	<u>2 South</u>	<u>11 East</u>	<u>MDB&M</u>
				<u>MDB&M</u>
				<u>MDB&M</u>
				<u>MDB&M</u>

RECORDER'S STAMP

in Pinal County, Az on the 14 day of December, 2011.

Name and mailing address of locator is:

Norman Montgomery
P.O. Box 941
Coolidge Az 85128

The Claim is approximately 1500 feet long and 600 feet wide, such that 0 feet
are claimed in a Northerly direction and 1500 feet in a Southerly direction from the point of
discovery (monument of location), at which the Notice of Location was posted, together with 300
feet on each side of the monument of location and center line of the Claim. The general course of the
lode or vein is from the Northeast to the Southeast direction.

The number, location and markings on each corner monument are as follows:

No.	Location	Markings	Description
No. 1:	<u>Northwest Corner</u>	<u>600 Ft</u>	<u>North 65° 20' East</u>
No. 2:	<u>Northeast Corner</u>	<u>1500 Ft</u>	<u>South 16° 28' East</u>
No. 3:	<u>Southeast Corner</u>	<u>600 Ft</u>	<u>South 65° 20' West</u>
No. 4:	<u>Southwest Corner</u>	<u>1500 Ft</u>	<u>North 16° 28' West</u>

As erected on the ground, each corner monument is marked as described above by
2 x 4 Post (e.g. metal tags, paint on posts).

The work of location consisted of making a claim map as provided in NRS 517.040.

Dated this 11 day of Dec, 2011.

NAME OF LOCATOR:

By Norman Montgomery
Owner, Claimant, or Agent Signature

Norman Montgomery

Owner, Claimant, or Agent Name (printed)

Suggested Form - Nevada Division of Minerals (REV. 4/15/2009 LV)

Nevada Lode Certificate of Location - NRS 517.050

Adjoining the Asia
And Alaska
Patented Claims MS2878A
to the Northeast.

ANCH 14305

RECEIVED
B.L.M. AZ STATE OFFICE
2012 MAR -7 P 12:00
PHOENIX, AZ

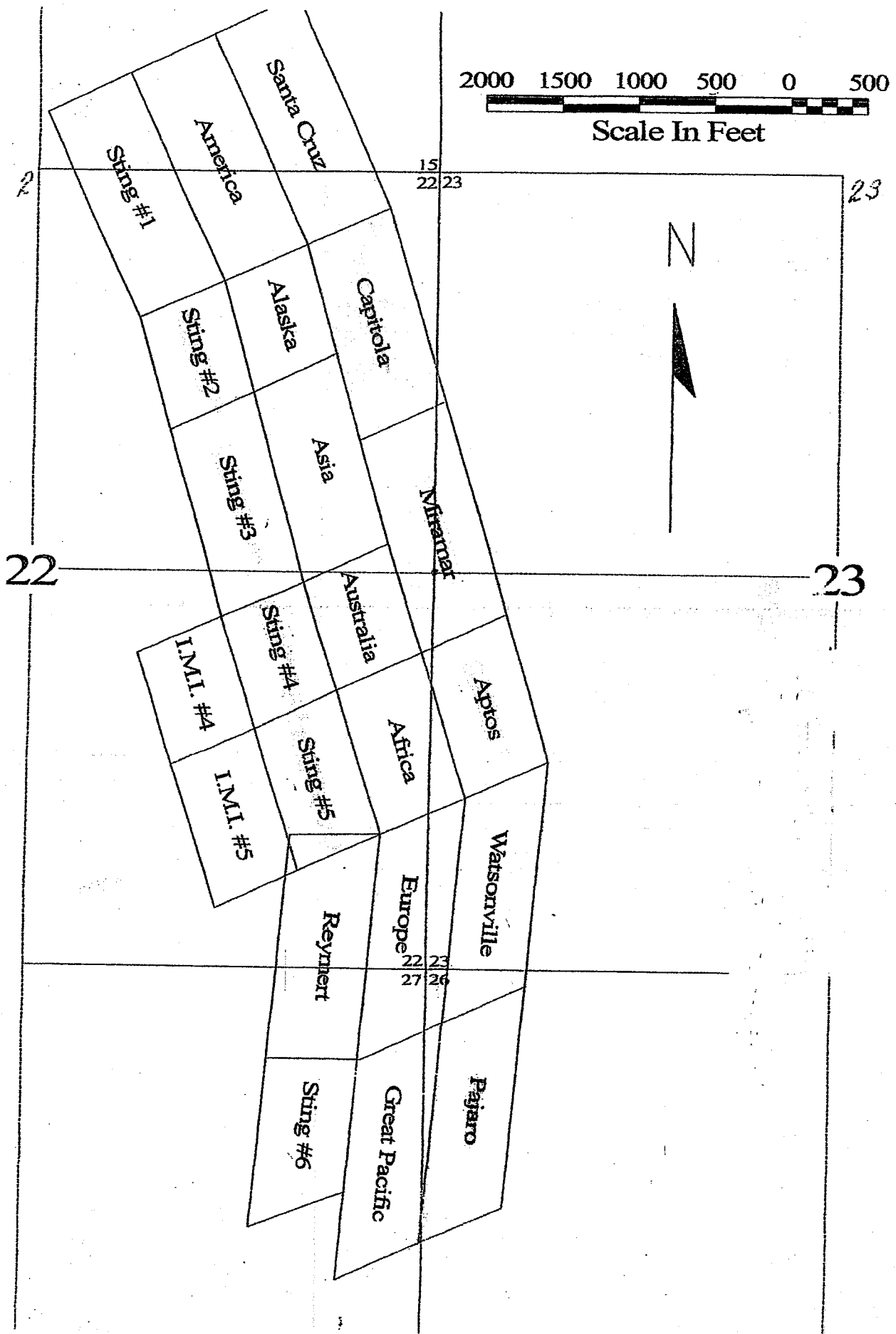

2P
Return to address
listed below



OFFICIAL RECORDS OF
PINAL COUNTY RECORDER
LAURA DEAN-LYTLE

DATE/TIME: 02/28/2012 1321
FEE: \$9.00
PAGES: 2
FEE NUMBER: 2012-015774



The following Document contains no Personal Information
as defined by NRS 603A.040

**CERTIFICATE OF LOCATION
LODE MINING CLAIM**

TO ALL WHOM IT MAY CONCERN:

The locator hereby certifies that he has caused to be located the
Micamar Lode Mining Claim in the
following quarter sections(s):

1/4	Section	Township	Range	Meridian
	<u>22 & 23</u>	<u>2 South</u>	<u>11 East</u>	<u>MDB&M</u>
				<u>MDB&M</u>
				<u>MDB&M</u>
				<u>MDB&M</u>

Adjoining the Australia?
Asia Patented Claims
MS287A to the Northeast

RECORDER'S STAMP

in Pinal County, Az. on the 14 day of December, 2011.

Name and mailing address of locator is:

Norman Montgomery
P.O. Box 941
Coolidge, Az 85128

20.66A
The Claim is approximately 1500 feet long and 600 feet wide, such that 0 feet
are claimed in a Southeast direction and 1500 feet in a Northwest direction from the point of
discovery (monument of location), at which the Notice of Location was posted, together with
feet on each side of the monument of location and center line of the Claim. The general course of the
lode or vein is from the Southeast to the Northwest direction.

The number, location and markings on each corner monument are as follows:

No.	Location	Markings	Description
No. 1:	<u>Northeast Corner</u>	<u>600 ft</u>	<u>North 65° 20' East</u>
No. 2:	<u>Southeast Corner</u>	<u>1500 ft</u>	<u>South 18° 22' East</u>
No. 3:	<u>Southwest Corner</u>	<u>600 ft</u>	<u>South 65° 20' West</u>
No. 4:	<u>Northwest Beginning</u>	<u>1500 ft</u>	<u>North 18° 22' West</u>

As erected on the ground, each corner monument is marked as described above by
2 x 4 post (e.g. metal tags, paint on posts).

The work of location consisted of making a claim map as provided in NRS 517.040.

Dated this 11 day of Dec., 2011.

NAME OF LOCATOR:

By Norman Montgomery
Owner, Claimant, or Agent Signature

Norman Montgomery
Owner, Claimant, or Agent Name (printed)

Suggested Form - Nevada Division of Minerals (REV. 4/15/2009 LV)
Nevada Lode Certificate of Location - NRS 517.050

RECEIVED
B.L.M. AZ STATE OFFICE
2012 MAR -7 P 12:00
PHOENIX, AZ

ANCH 14306

Scale In Feet

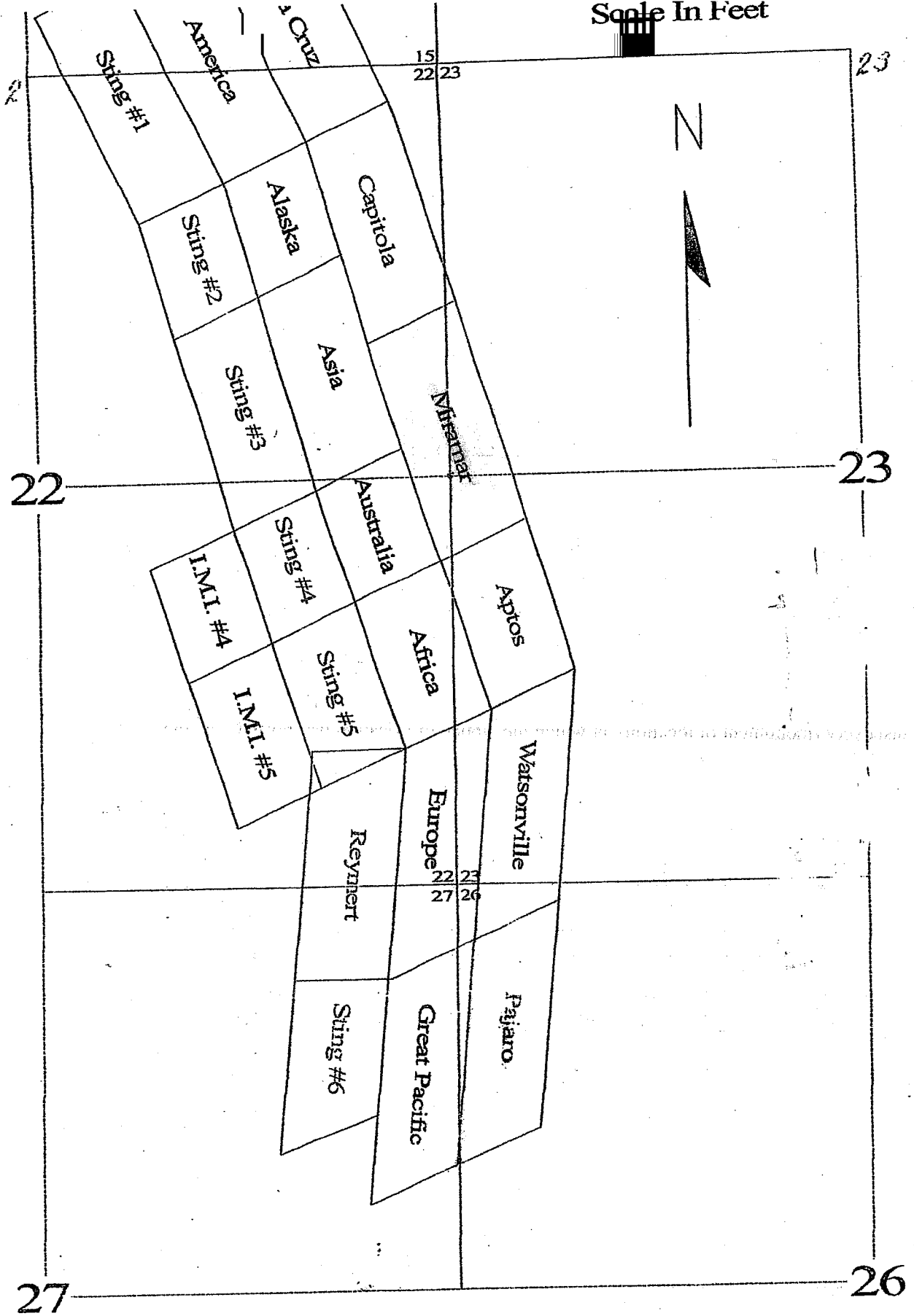

DP
Return to address
listed below



OFFICIAL RECORDS OF
PINAL COUNTY RECORDER
LAURA DEAN-LYTLE

DATE/TIME: 02/28/2012 1321
FEE: \$9.00
PAGES: 1
FEE NUMBER: 2012-015779



The following Document contains no Personal Information
as defined by NRS 603A.040

**CERTIFICATE OF LOCATION
LODE MINING CLAIM**

TO ALL WHOM IT MAY CONCERN:

The locator hereby certifies that he has caused to be located the
Sting 1 Lode Mining Claim in the
following quarter sections(s):

1/4	Section	Township	Range	Meridian
	<u>15 & 22</u>	<u>2 South</u>	<u>11 East</u>	<u>MDB&M</u>
				<u>MDB&M</u>
				<u>MDB&M</u>
				<u>MDB&M</u>

Adjoining the America
Patented Claim MS2878 A
to the Southwest.

RECORDER'S STAMP

in Pinal County, AZ, on the 16 day of December, 2011.

Name and mailing address of locator is:

Norman Montgomery
PO Box 941
Coolidge AZ 85128

20.48A
The Claim is approximately 1487 feet long and 1000 feet wide, such that 0 feet
are claimed in a Northerly direction and 1487 feet in a Southerly direction from the point of
discovery (monument of location), at which the Notice of Location was posted, together with 300
feet on each side of the monument of location and center line of the Claim. The general course of the
lode or vein is from the N. East to the S. West direction.

The number, location and markings on each corner monument are as follows:

No.	Location	Markings	Description
No. 1:			
No. 2:			
No. 3:			
No. 4:			

As erected on the ground, each corner monument is marked as described above by
(e.g. metal tags, paint on posts).

The work of location consisted of making a claim map as provided in NRS 517.040.

Dated this 14 day of DEC, 2011.

NAME OF LOCATOR:

By Norman Montgomery
Owner, Claimant, or Agent Signature

NORMAN MONTGOMERY
Owner, Claimant, or Agent Name (printed)

Suggested Form - Nevada Division of Minerals (REV. 4/15/2009 LV)
Nevada Lode Certificate of Location - NRS 517.050

RECEIVED
B.L.M. AZ STATE OFFICE
2012 MAR - 7 P 12:00
PHOENIX, AZ

APR 13 2012

10:08 A
S. Cruz called
Mr. Montgomery came in to sign

ANCH 14307

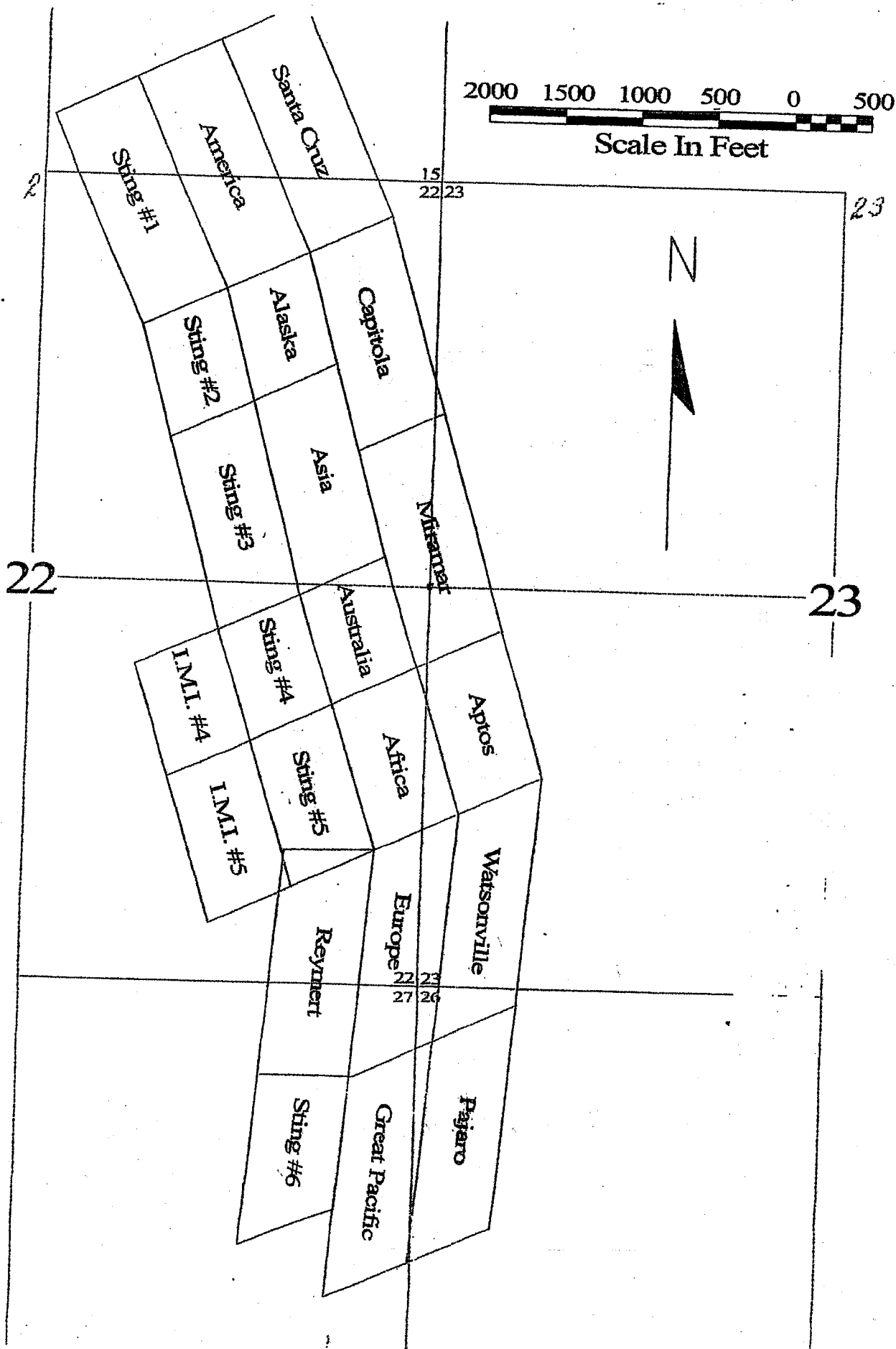

Return to address
listed below

The following Document contains no Personal Information
as defined by NRS 603A.040

**CERTIFICATE OF LOCATION
LODE MINING CLAIM**

TO ALL WHOM IT MAY CONCERN:

The locator hereby certifies that he has caused to be located the
String 2 Lode Mining Claim in the
following quarter sections(s):

1/4	Section	Township	Range	Meridian
	<u>22:NE 1/4</u>	<u>2 South</u>	<u>11 East</u>	<u>MDB&M</u>
				<u>MDB&M</u>
				<u>MDB&M</u>
				<u>MDB&M</u>

RECORDER'S STAMP

in Pinal County, AZ, on the 14 day of December, 20 11.

Name and mailing address of locator is:

Norman Montgomery
P.O. Box 941
Coolidge Az. 85128

The Claim is approximately 752 feet long and 600 feet wide, such that 0 feet
are claimed in a Southeast direction and 752 feet in a Northwest direction from the point of
discovery (monument of location), at which the Notice of Location was posted, together with 300
feet on each side of the monument of location and center line of the Claim. The general course of the
lode or vein is from the Southeast to the Northwest direction.

The number, location and markings on each corner monument are as follows:

No.	Location	Markings	Description
No. 1:	<u>Northeast Corner</u>	<u>600 Ft</u>	<u>North 65° 20' Pt east</u>
No. 2:	<u>Northeast Corner</u>	<u>752 Ft</u>	<u>South 110° 28' East</u>
No. 3:	<u>Southeast Corner</u>	<u>600 Ft</u>	<u>South 65° 20' West</u>
No. 4:	<u>Southwest Corner</u>	<u>752 Ft</u>	<u>North 110° 28' West</u>

As erected on the ground, each corner monument is marked as described above by
2x4 Post (e.g. metal tags, paint on posts).

The work of location consisted of making a claim map as provided in NRS 517.040.

Dated this 11 day of Dec, 20 11.

NAME OF LOCATOR:

By Norman Montgomery
Owner, Claimant, or Agent Signature

Norman Montgomery
Owner, Claimant, or Agent Name (printed)

Suggested Form - Nevada Division of Minerals (REV. 4/15/2009 LV)

Nevada Lode Certificate of Location - NRS 517.050

RECEIVED
B.L.M. AZ STATE OFFICE
2012 MAR - 7 P 12:00
PHOENIX, AZ

ANCH 14308

Adjoining the Alaska
Patented Claim MS 2878A
to the Southwest

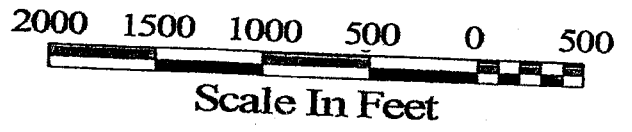

N

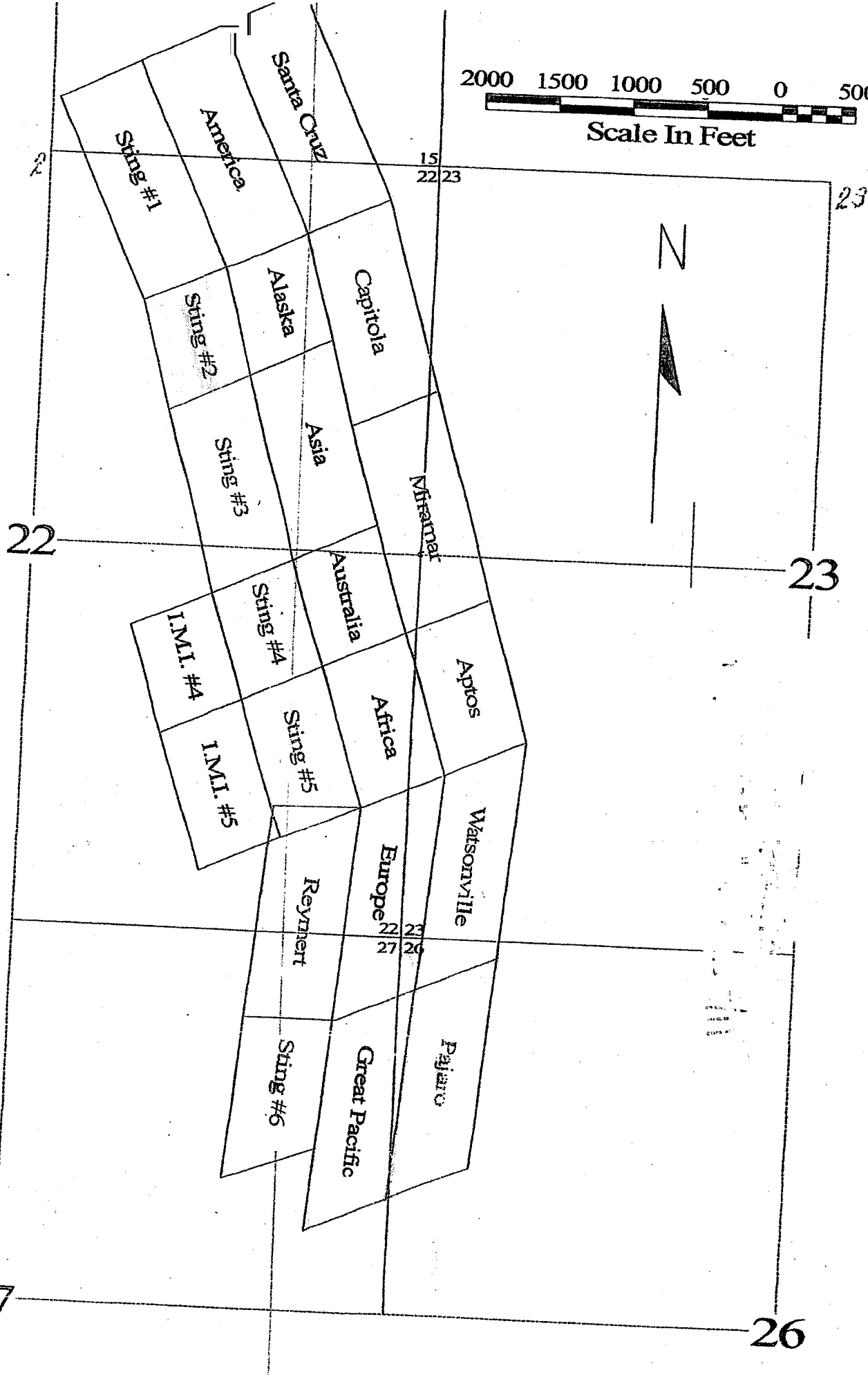

2R

Return to address
listed below



OFFICIAL RECORDS OF
PINAL COUNTY RECORDER
LAURA DEAN-LYTTLE

DATE/TIME: 02/28/2012 1321
FEE: \$9.00
PAGES: 2
FEE NUMBER: 2012-015777



The following Document contains no Personal Information
as defined by NRS 603A.040

**CERTIFICATE OF LOCATION
LODE MINING CLAIM**

TO ALL WHOM IT MAY CONCERN:

The locator hereby certifies that he has caused to be located the
Slings 3 Lode Mining Claim in the
following quarter sections(s):

1/4	Section	Township	Range	Meridian
	<u>22</u>	<u>2 South</u>		<u>MDB&M</u>
				<u>MDB&M</u>
				<u>MDB&M</u>
				<u>MDB&M</u>

11 East Adjoining the Asia
Patented Claim MS 2878 A
to the Southwest

RECORDER'S STAMP

in Pinal County, Az. on the 14 day of December, 2011.

Name and mailing address of locator is:

Norman Montgomery
P.O. Box 941
Coolidge Az 85128

17.89 A
The Claim is approximately 1299 feet long and 600 feet wide, such that 0 feet
are claimed in a Northwest direction and 1299 feet in a southeast direction from the point of
discovery (monument of location), at which the Notice of Location was posted, together with 300
feet on each side of the monument of location and center line of the Claim. The general course of the
lode or vein is from the Northwest to the Southeast direction.

The number, location and markings on each corner monument are as follows:

	Location	Markings	Description
No. 1:	<u>Northwest Corner</u>	<u>600 Ft</u>	<u>North 65° 20' East</u>
No. 2:	<u>Northeast Corner</u>	<u>1299 Ft</u>	<u>South 15° 23' East</u>
No. 3:	<u>Southeast Corner</u>	<u>600 Ft</u>	<u>South 65° 20' West</u>
No. 4:	<u>Southwest Corner</u>	<u>1299 Ft</u>	<u>North 15° 33' West</u>

As erected on the ground, each corner monument is marked as described above by
2x4 post (e.g. metal tags, paint on posts).

The work of location consisted of making a claim map as provided in NRS 517.040.

Dated this 11 day of Dec, 2011.

NAME OF LOCATOR:

By Norman Montgomery
Owner, Claimant, or Agent Signature

Norman Montgomery
Owner, Claimant, or Agent Name (printed)

Suggested Form - Nevada Division of Minerals (REV. 4/15/2009 LV)
Nevada Lode Certificate of Location - NRS 517.050

PHOENIX, AZ

2012 MAR -7 P 12:00

RECEIVED
B.L.M. AZ STATE OFFICE

ANCH 14309

Scale In Feet

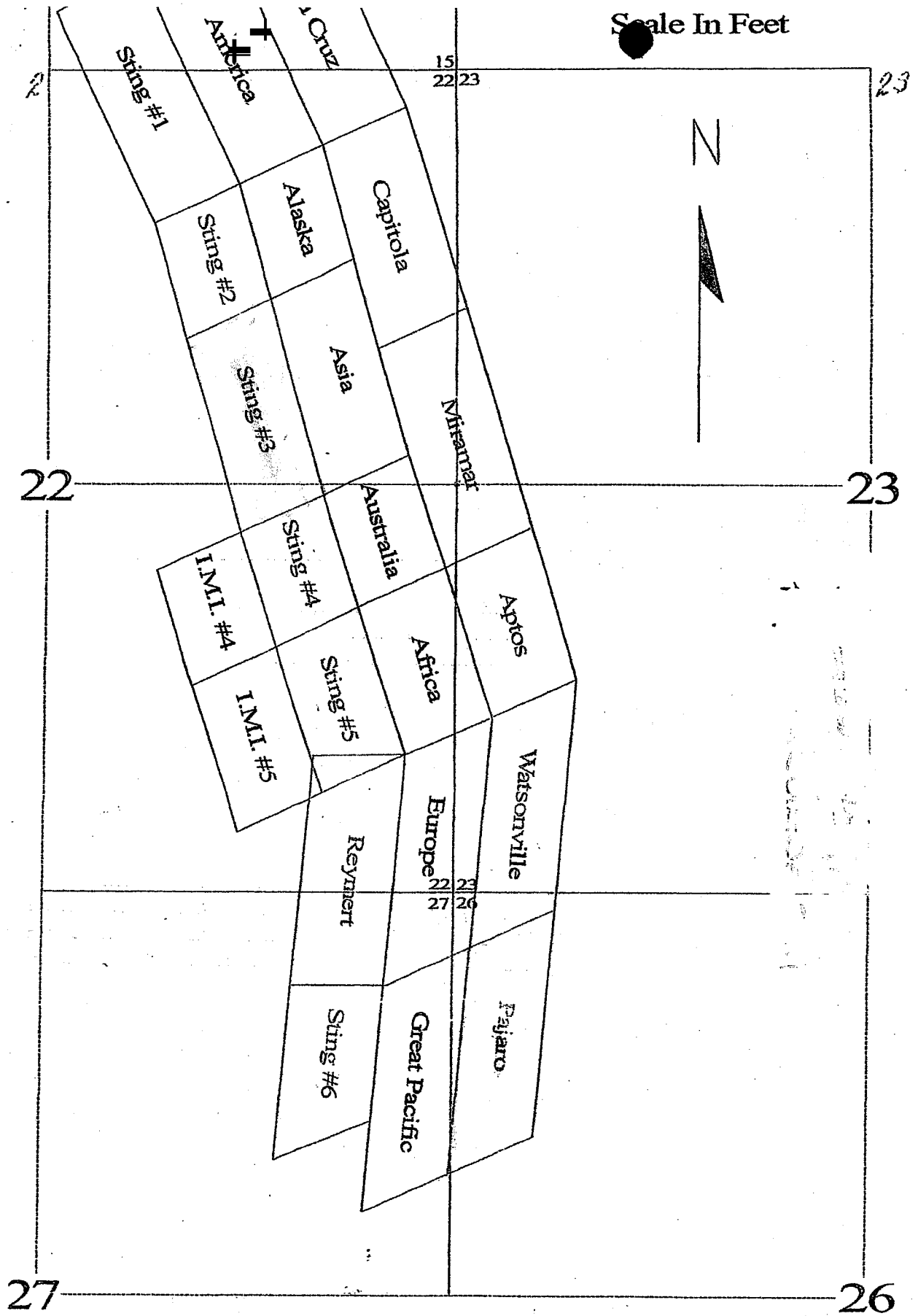

2R
Return to address
listed below



OFFICIAL RECORDS OF
PINAL COUNTY RECORDER
LAURA DEAN-LYTLE

The following Document contains no Personal Information
as defined by NRS 603A.040

DATE/TIME: 02/28/2012 1321
FEE: \$9.00
PAGES: 2
FEE NUMBER: 2012-015776



**CERTIFICATE OF LOCATION
LODE MINING CLAIM**

TO ALL WHOM IT MAY CONCERN:

The locator hereby certifies that he has caused to be located the
String 4 Lode Mining Claim in the
following quarter sections(s):

1/4	Section	Township	Range	Meridian
	<u>22</u>	<u>2 South</u>		<u>MDB&M</u>
				<u>MDB&M</u>
				<u>MDB&M</u>
				<u>MDB&M</u>

11 east, Adjoining the Australia
Patented Claim MS2878 A
to the Southwest

RECORDER'S STAMP

in Pinal County, AZ. on the 14 day of December, 2011.

Name and mailing address of locator is:

Norman Montgomery
PO Box 941
Coolidge AZ 85128

10.55 A
The Claim is approximately 760 feet long and 1000 feet wide, such that 0 feet
are claimed in a Southeast direction and 760 feet in a Northwest direction from the point of
discovery (monument of location), at which the Notice of Location was posted, together with 300
feet on each side of the monument of location and center line of the Claim. The general course of the
lode or vein is from the Southeast to the Northwest direction.

The number, location and markings on each corner monument are as follows:

No.	Location	Markings	Description
No. 1:	<u>Northwest Corner</u>	<u>600 Ft</u>	<u>North 105° 20' East</u>
No. 2:	<u>Northeast Corner</u>	<u>760 Ft</u>	<u>South 18° 22' East</u>
No. 3:	<u>Southeast Corner</u>	<u>600 Ft</u>	<u>South 105° 20' West</u>
No. 4:	<u>Southwest Corner</u>	<u>760 Ft</u>	<u>North 18° 22' West</u>

As erected on the ground, each corner monument is marked as described above by
2x4 post (e.g. metal tags, paint on posts).

The work of location consisted of making a claim map as provided in NRS 517.040.

Dated this 11 day of Dec, 2011.

NAME OF LOCATOR:

By Norman Montgomery
Owner, Claimant, or Agent Signature

Norman Montgomery
Owner, Claimant, or Agent Name (printed)

Suggested Form - Nevada Division of Minerals (REV. 4/15/2009 LV)
Nevada Lode Certificate of Location - NRS 517.050

RECEIVED
B.L.M. AZ STATE OFFICE
2012 MAR - 7 P 12: 00
PHOENIX, AZ

ANCH14310

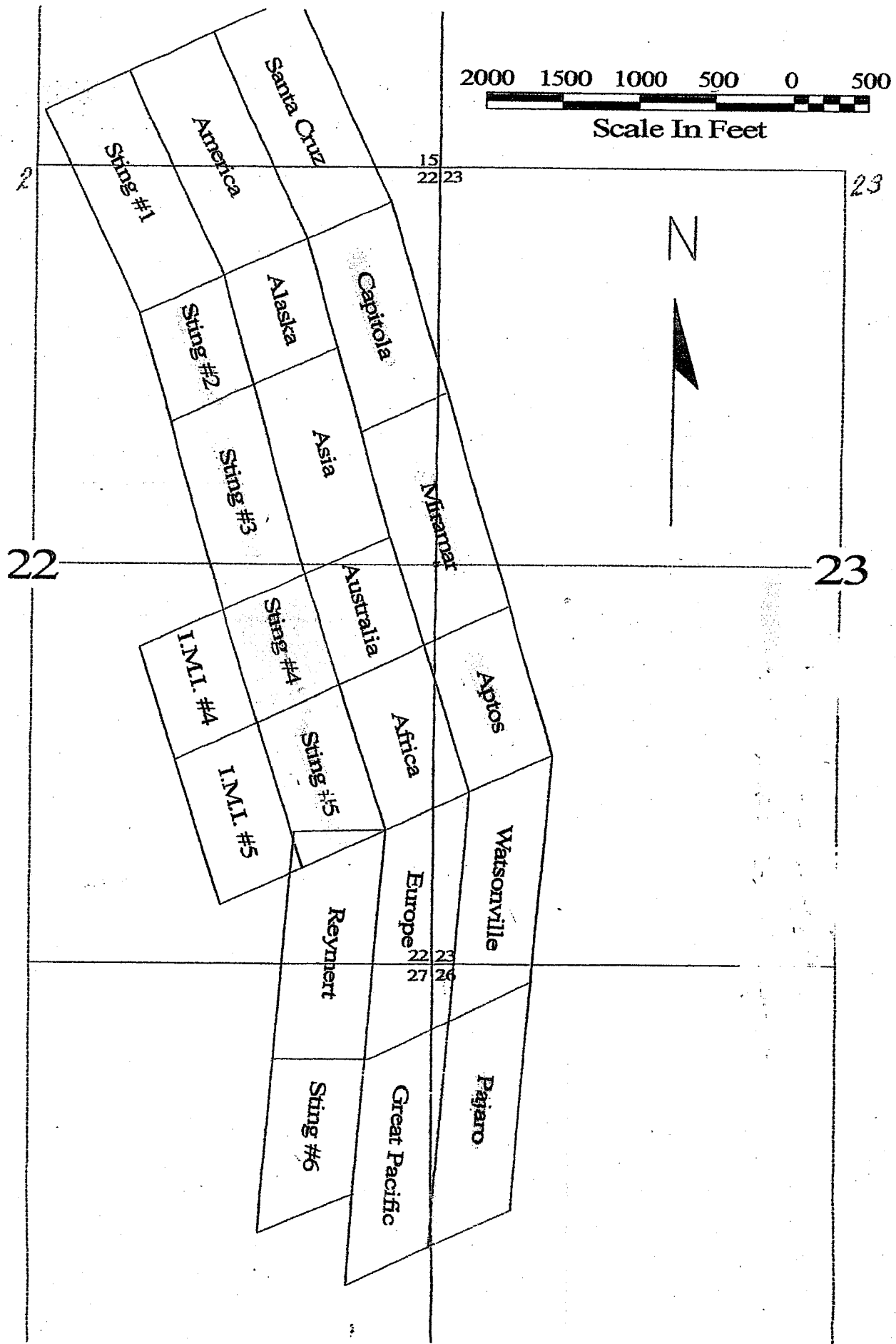

2P
Return to address
listed below



OFFICIAL RECORDS OF
PINAL COUNTY RECORDER
LAURA DEAN-LYTLE

The following Document contains no Personal Information
as defined by NRS 603A.040

**CERTIFICATE OF LOCATION
LODE MINING CLAIM**

DATE/TIME: 02/28/2012 1321
FEE: \$9.00
PAGES: 2
FEE NUMBER: 2012-015775



TO ALL WHOM IT MAY CONCERN:

The locator hereby certifies that he has caused to be located the
String 5 Lode Mining Claim in the
following quarter sections(s):

1/4	Section	Township	Range	Meridian
	<u>22</u>	<u>2 South</u>		<u>MDB&M</u>
				<u>MDB&M</u>
				<u>MDB&M</u>
				<u>MDB&M</u>

11 East, Adjoining the Africa
Patented Claim Ms 2878 A
to the Southwest.

RECORDER'S STAMP

in Pinal County, AZ. on the 14 day of December, 2011.

Name and mailing address of locator is:

Norman Montgomery
P.O. Box 941
Coolidge Az 85128

13-86-A
The Claim is approximately 1000 feet long and 600 feet wide, such that 0 feet
are claimed in a Northwest direction and 1000 feet in a Southeast direction from the point of
discovery (monument of location), at which the Notice of Location was posted, together with 300
feet on each side of the monument of location and center line of the Claim. The general course of the
lode or vein is from the Northwest to the Southeast direction.

The number, location and markings on each corner monument are as follows:

No.	Location	Markings	Description
No. 1:	<u>Northwest Corner</u>	<u>600 Ft</u>	<u>North 65° 20' East</u>
No. 2:	<u>Northeast Corner</u>	<u>100 10 Ft</u>	<u>South 17° 45' East</u>
No. 3:	<u>Southeast Corner</u>	<u>600 Ft</u>	<u>South 65° 20' West</u>
No. 4:	<u>Southwest Corner</u>	<u>100 10 Ft</u>	<u>North 17° 45' West</u>

As erected on the ground, each corner monument is marked as described above by
2 x 4 post (e.g. metal tags, paint on posts).

The work of location consisted of making a claim map as provided in NRS 517.040.

Dated this 11 day of DEC., 2011.

NAME OF LOCATOR:

By Norman Montgomery
Owner, Claimant, or Agent Signature

Norman Montgomery
Owner, Claimant, or Agent Name (printed)

Suggested Form - Nevada Division of Minerals (REV. 4/15/2009 LV)
Nevada Lode Certificate of Location - NRS 517.050

RECEIVED
B.L.M. AZ STATE OFFICE
2012 MAR - 7 P 12:00
PHOENIX, AZ

ANCH 14311

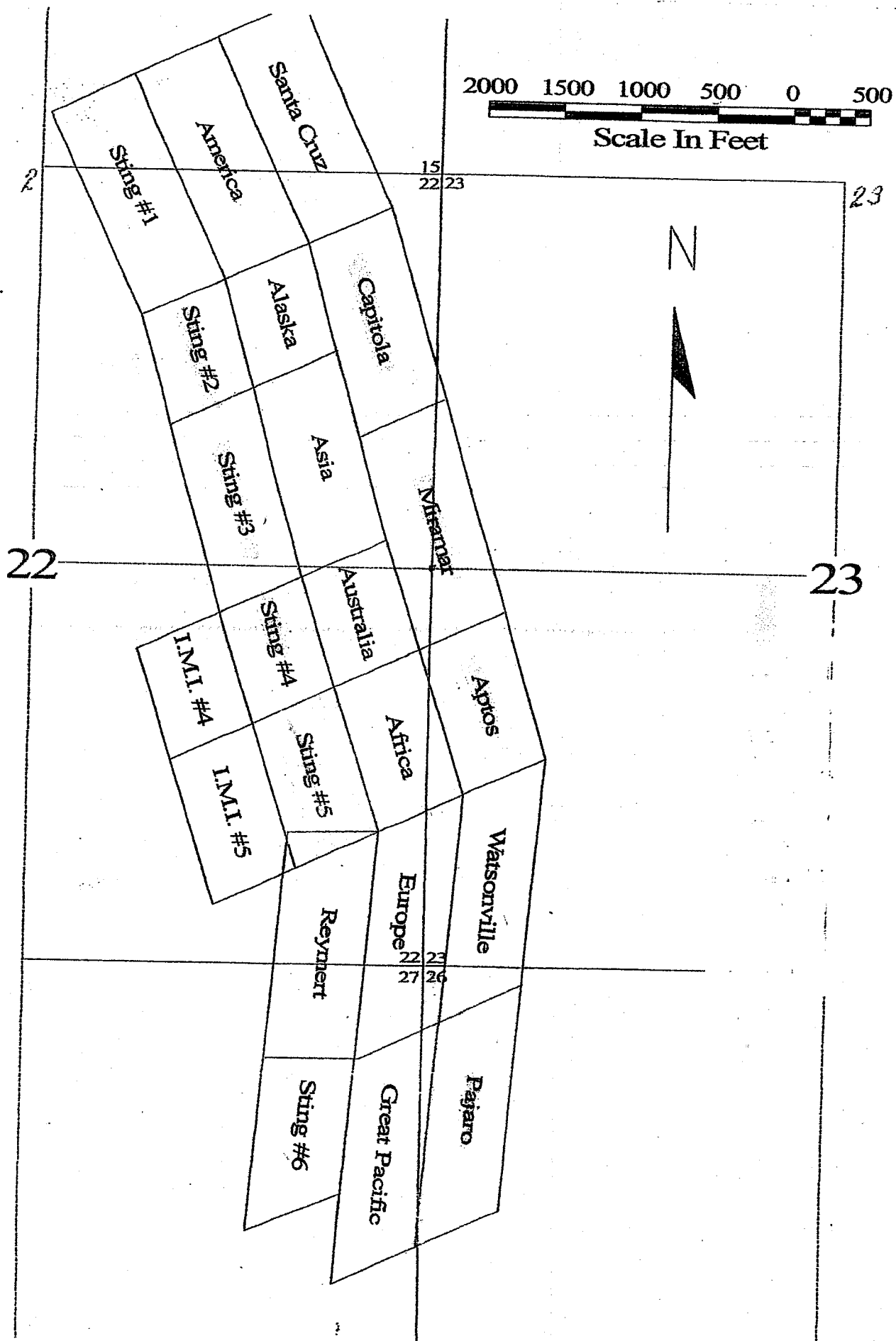

RUN TIME: 07:22 AM

DEPARTMENT OF INTERIOR
BUREAU OF LAND MANAGEMENT

RUN DATE: 03/16/2012
Page 1 of 1

Input Parameters for Geographic Report with Land

System Id = CR

Admin State = AZ

Geo State = AZ

Casetype Begins With

Case Disp Txt = AUTHORIZED, CANCELLED, EXPIRED, PENDING, REJECTED, RELINQUISHED, WITHDRAWN

Mer Twp Rng =

Section =

Mtrs = 14 0020S 0110E 015, 14 0020S 0110E 022, 14 0020S 0110E 023, 14 0020S 0110E 999

Commodity =

Commodity Txt =

Pending Org =

Pend Org Decode =

Total Rows Returned: 0

NO WARRANTY IS MADE BY BLM FOR USE OF THE DATA
FOR PURPOSES NOT INTENDED BY BLM

PINAL COUNTY
LOWER SONORAN / TUCSON FIELD OFFICE

[illegible]

Lat	33°12'10"N
Long	111°09'57"W

CURRENT TO	NW	GSR Mer
5-9-2011	ACAD	T 2 S
		R 11 E

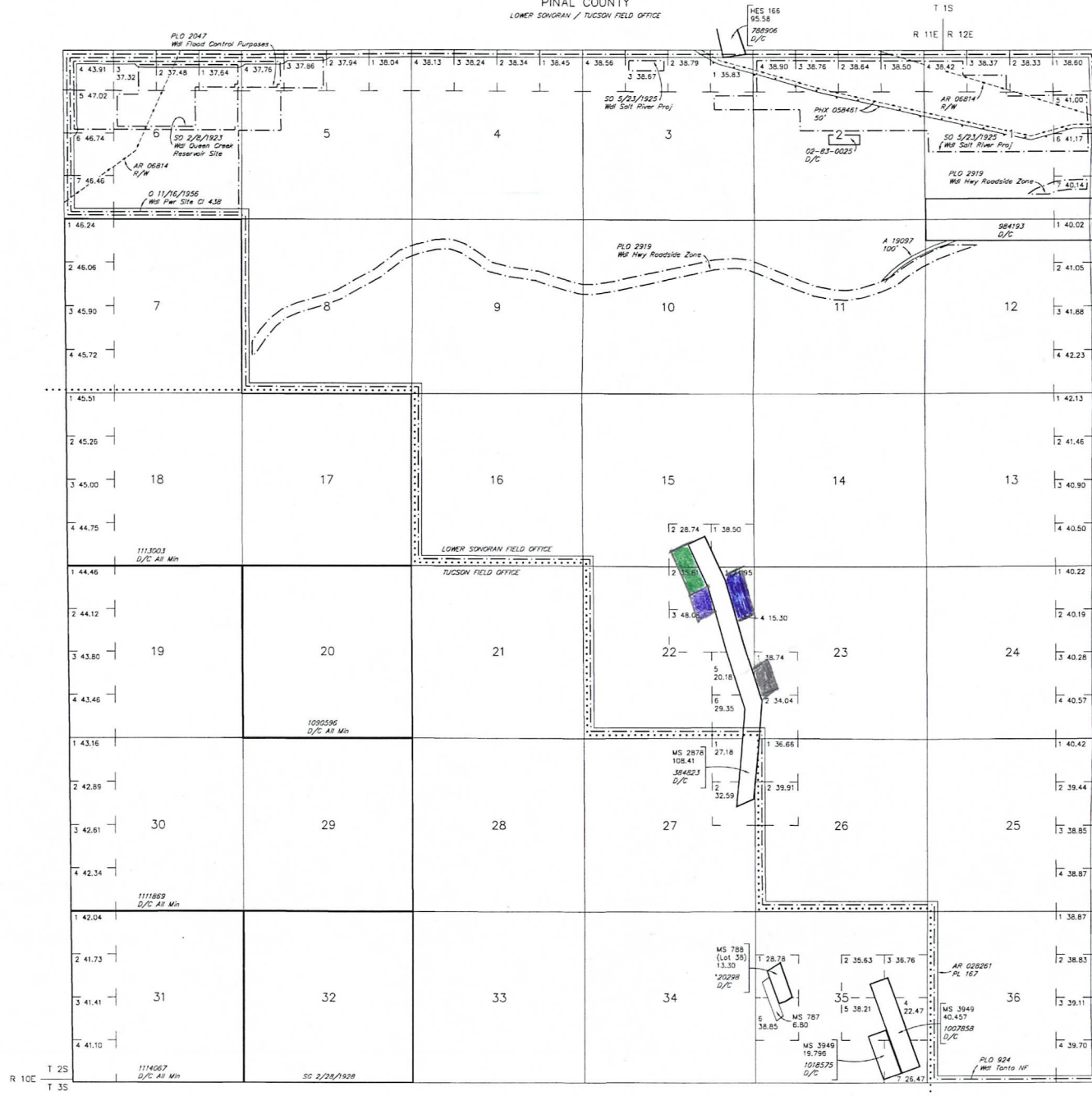

SCALE in chains

WARNING STATEMENT
This plot is the Bureau's Record of Title, and should be used only as a graphic display of the township survey data. Records hereon do not reflect title changes which may have been effected by lateral movements of rivers or other bodies of water. Refer to the cadastral surveys for official survey information.